

Sanitärsysteme

Roth Melina MI FXP

Roth

GB D F CZ

Assembly instructions
Montageanleitung
Notice de montage
Montážní návod



Leben voller Energie

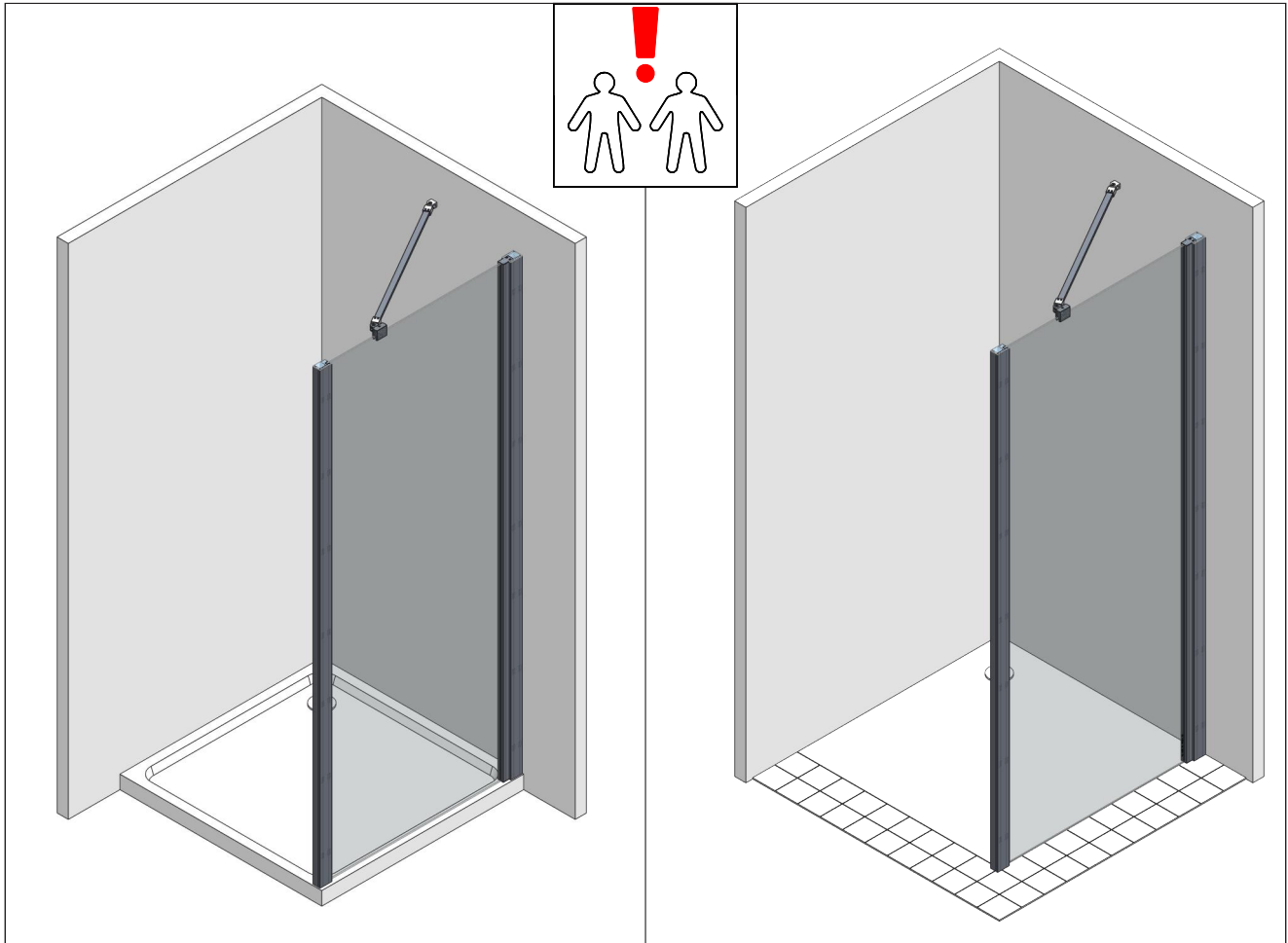

1x

!
 Use these components from combined
 shower enclosure
 Diese Komponenten aus kombinierter
 Abtrennung entnehmen
 Utiliser les composants de la cabine de
 douche combinée
 Použijte tyto komponenty z kombinovaného
 sprchového koutu

3x		3x	1x
3x			3x
1x			4x
1x			

3x		1x	1x
3x			1x
3x			1x
4x			1x
3x			1x

1x

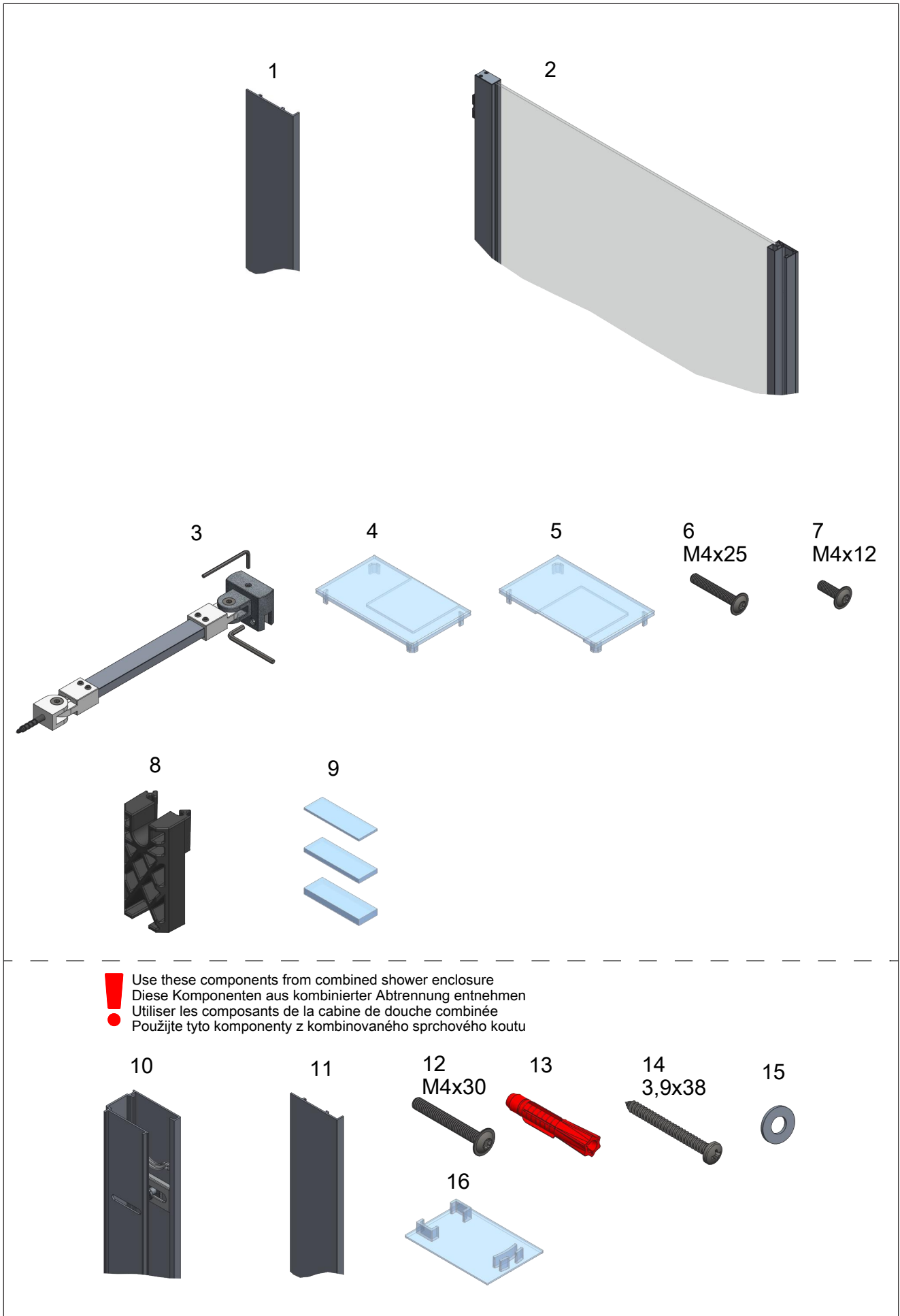

Use these components from combined shower enclosure
 Diese Komponenten aus kombinierter Abtrennung entnehmen
 Utiliser les composants de la cabine de douche combinée
 Použijte tyto komponenty z kombinovaného sprchového koutu

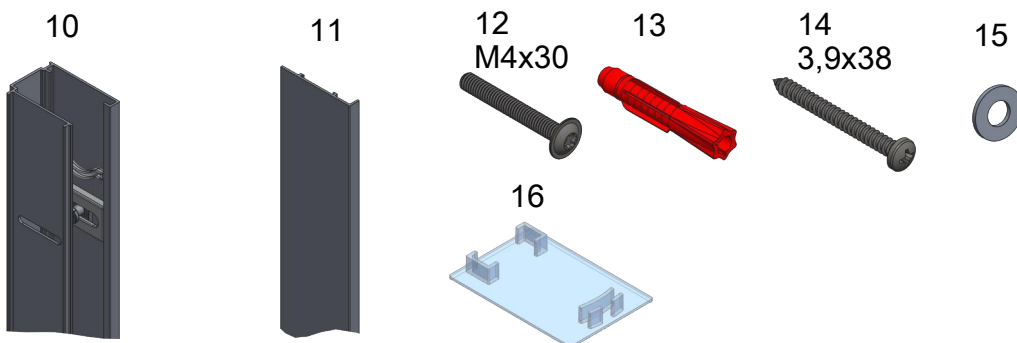

Modification delivery condition (small) to large setting (+25mm)
Umbau Auslieferungszustand (klein) auf große Einstellung (+25mm)
Modification de l'état de livraison (petit) en grand réglage (+25mm)
Úprava dodací podmínky (malá) na velké nastavení (+25 mm)

Delivery condition / Auslieferungszustand
État à la livraison / Stav při dodání

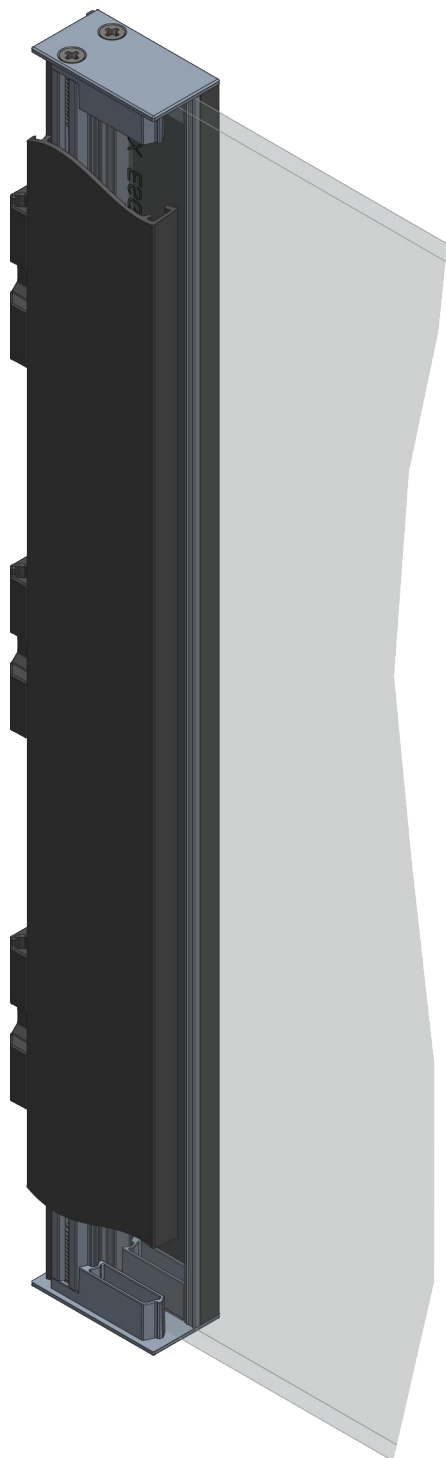

Modification +25 mm / Umbau +25mm
Modification +25mm / Modifikace +25mm

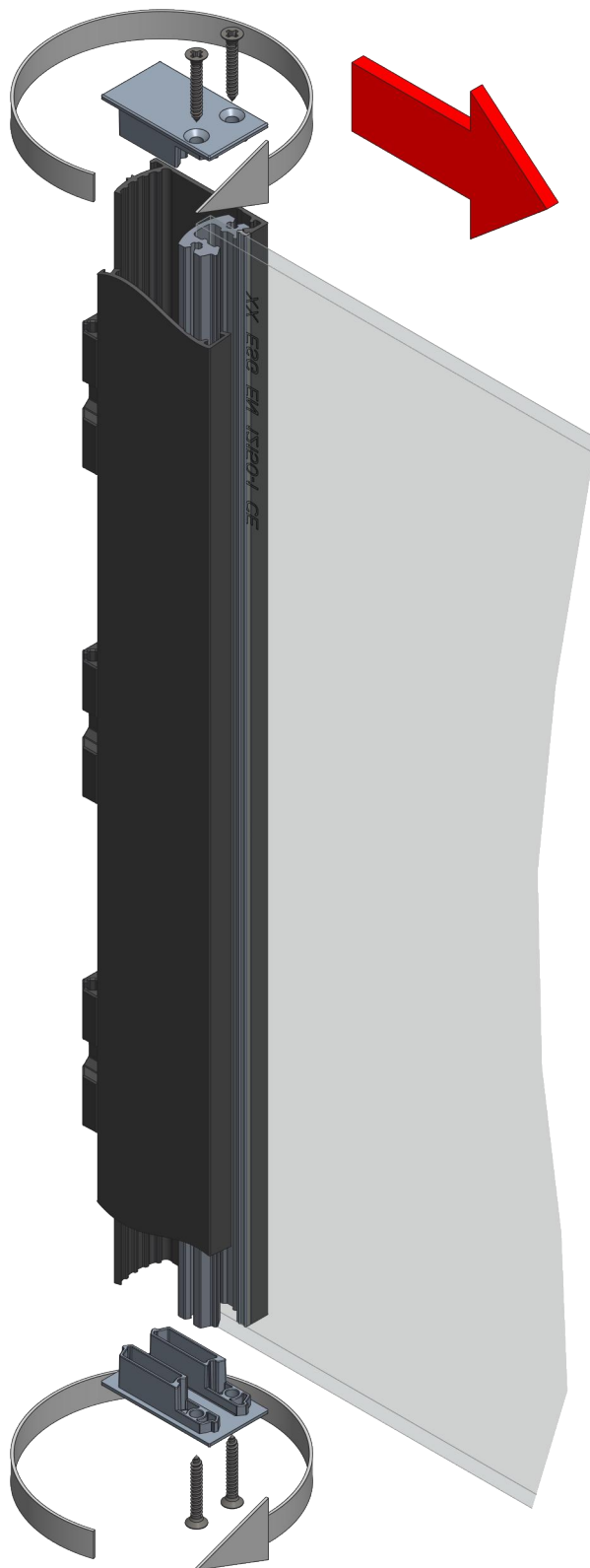

Subject to technical modification! Warranty service only if these instructions are followed.
Technische Änderungen vorbehalten! Garantieleistung nur bei Beachtung dieser Anweisungen.
Sous réserve de modifications techniques! Garantie uniquement si ces instructions sont respectées.
S výhradou technických změn! Záruční servis pouze při dodržení těchto pokynů

■ MI FXP

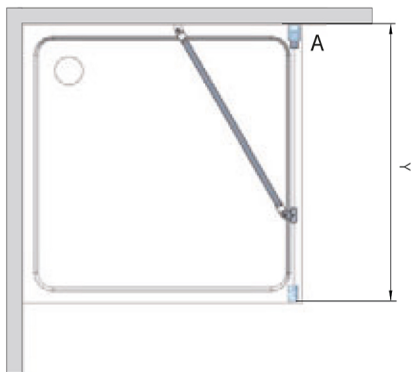

A

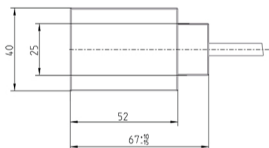

Stav při dodání



Modifikace +25 mm



Varianta	Y (mm)
800	780–830
900	880–930
1000	980–1030

Rozměry včetně modifikace +25 mm

Mounting on shower tray / Montage auf Duschwanne
 Montage sur receveur de douche / Montáž na sprchovou vaničku

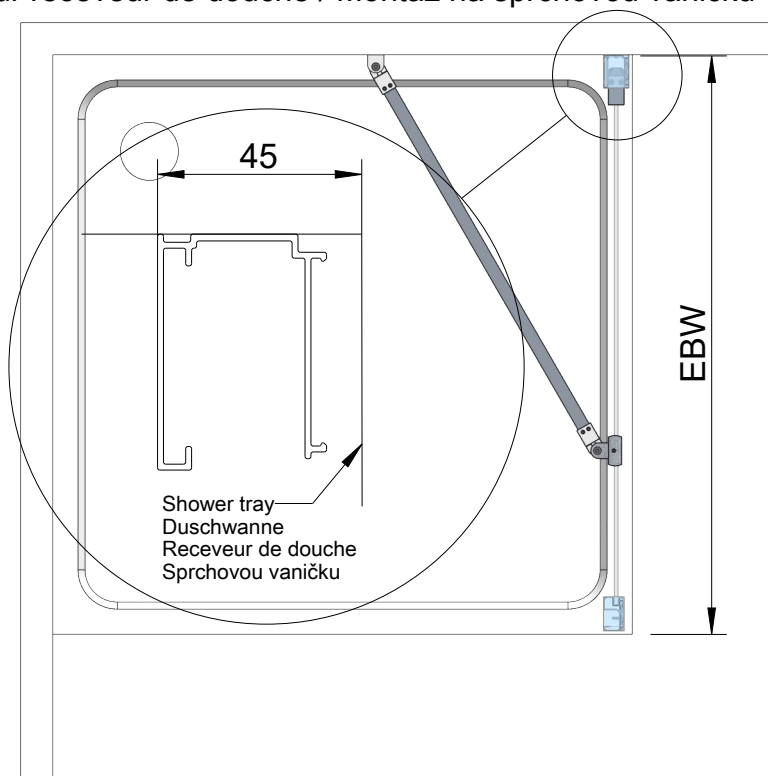

Delivery condition / Auslieferungszustand
 État à la livraison / Stav při dodání

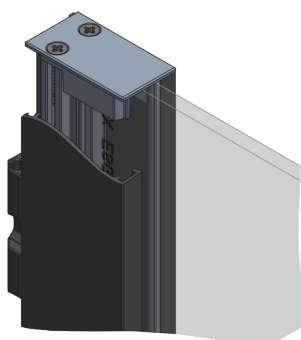

Modification +25 mm / Umbau +25mm
 Modification +25mm / Modifikace +25mm

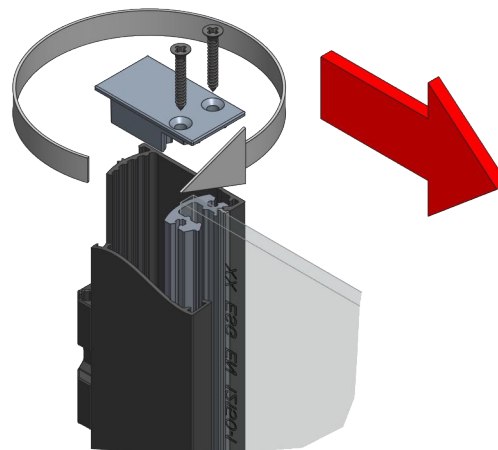

MI FXP	EBW	EBW +25
070	685 - 710	710 - 735
075	735 - 760	760 - 785
080	785 - 810	810 - 835
085	835 - 860	860 - 885
090	885 - 910	910 - 935
095	935 - 960	960 - 985
100	985 - 1010	1010 - 1035
105	1035 - 1060	1060 - 1085
110	1085 - 1110	1110 - 1135
115	1135 - 1160	1160 - 1185
120	1185 - 1210	1210 - 1235

Mounting on floor / Montage auf Boden
 Montage au sol / Montáž na podlahu

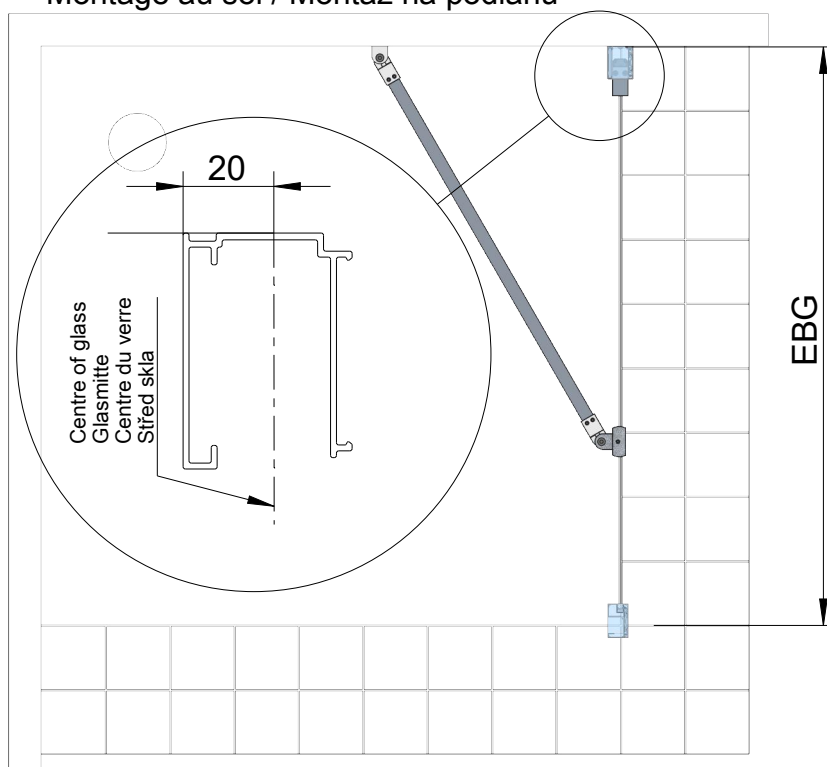

Delivery condition / Auslieferungszustand
 État à la livraison / Stav při dodání

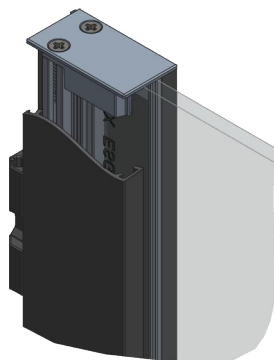

Modification +25 mm / Umbau +25mm
 Modification +25mm / Modifikace +25mm

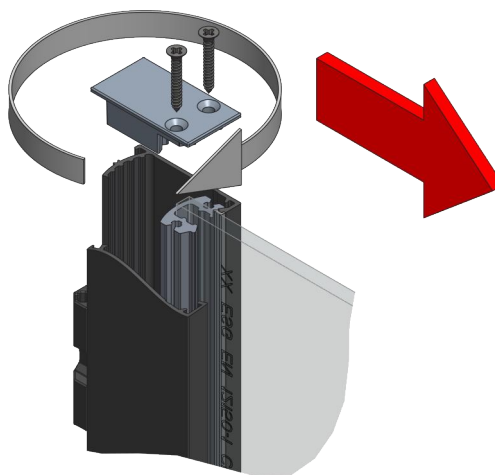

MI FXP	EBG	EBG +25
070	660 - 685	685 - 710
075	710 - 735	735 - 760
080	760 - 785	785 - 810
085	810 - 835	835 - 860
090	860 - 885	885 - 910
095	910 - 935	935 - 960
100	960 - 985	985 - 1010
105	1010 - 1035	1035 - 1060
110	1060 - 1085	1085 - 1110
115	1110 - 1135	1135 - 1160
120	1160 - 1185	1185 - 1210

Subject to technical modification! Warranty service only if these instructions are followed.
 Technische Änderungen vorbehalten! Garantieleistung nur bei Beachtung dieser Anweisungen.
 Sous réserve de modifications techniques! Garantie uniquement si ces instructions sont respectées.
 S výhradou technických změn! Záruční servis pouze při dodržení těchto pokynů

1

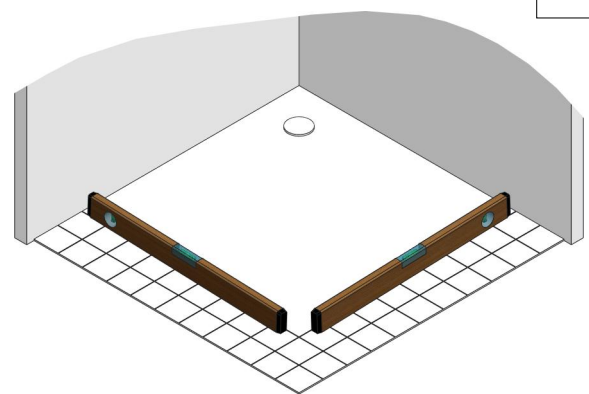
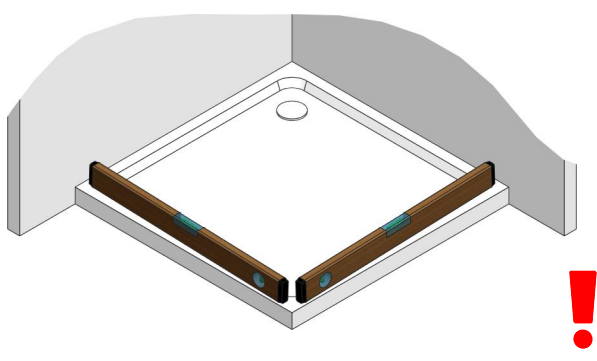

Floor level max. ± 5 mm / Bodenniveau max. ± 5 mm / Niveau du sol max. ± 5 mm / Úroveň podlahy max. ± 5 mm

2

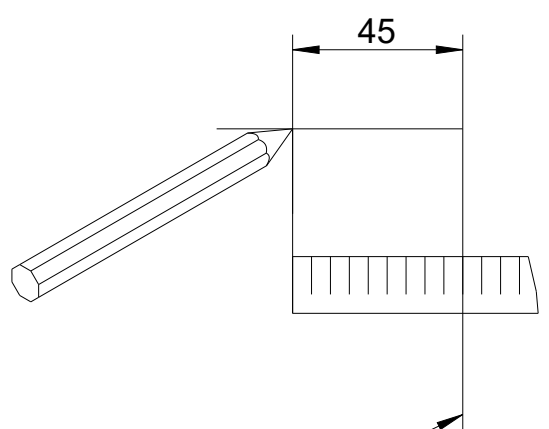

Installation dimension shower tray
Einbaumaß Duschwanne
Dimension de montage du receveur de douche
Instalační rozměr sprchové vaničky

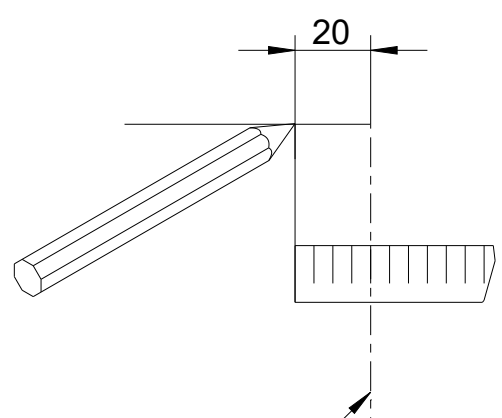

Installation dimension glass centre
Einbaumaß Glasmitte
Dimension de montage centre du verre
Instalační rozměr skleněného středu



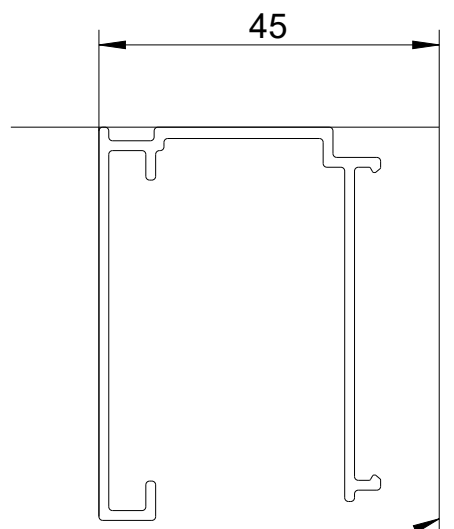

3

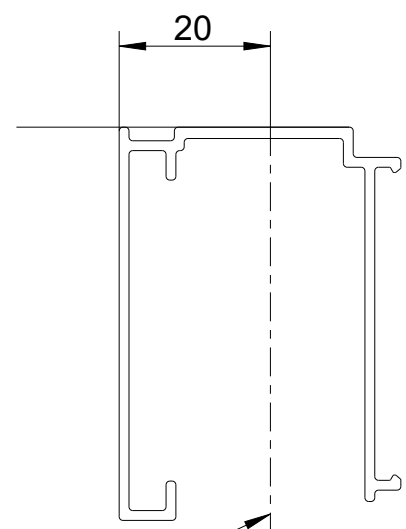

Shower tray
Duschwanne
Receveur de douche
Sprchovou vaničku



Centre of glass
Glasmitte
Centre du verre
Střed skla

- 13 
- 10 
- 15 
- 14 3,9x38 

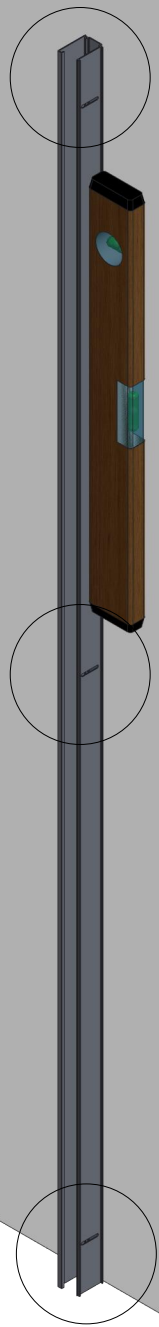
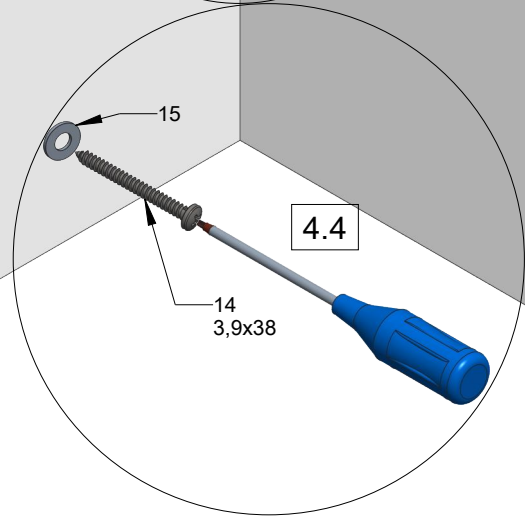
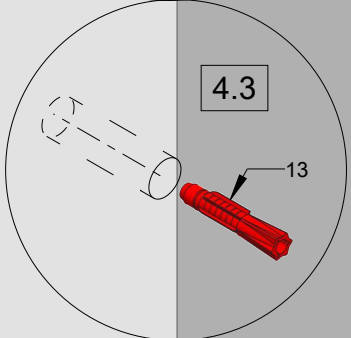
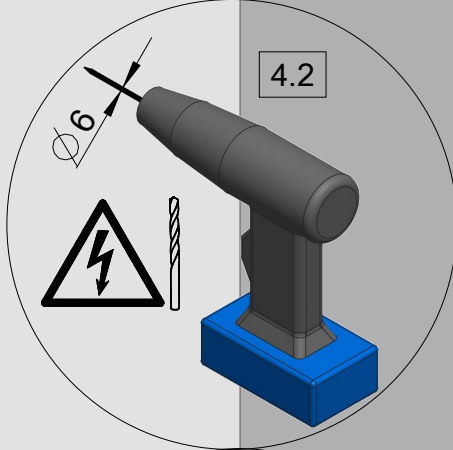
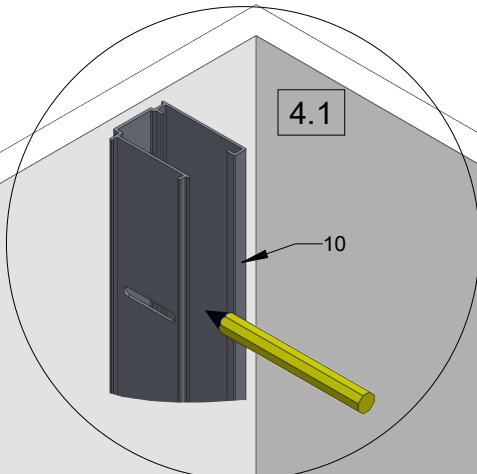

Subject to technical modification! Warranty service only if these instructions are followed.
Technische Änderungen vorbehalten! Garantieleistung nur bei Beachtung dieser Anweisungen.
Sous réserve de modifications techniques! Garantie uniquement si ces instructions sont respectées.
S výhradou technických změn! Záruční servis pouze při dodržení těchto pokynů

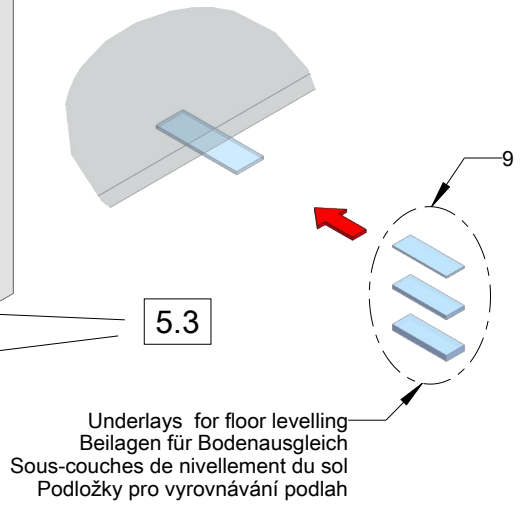
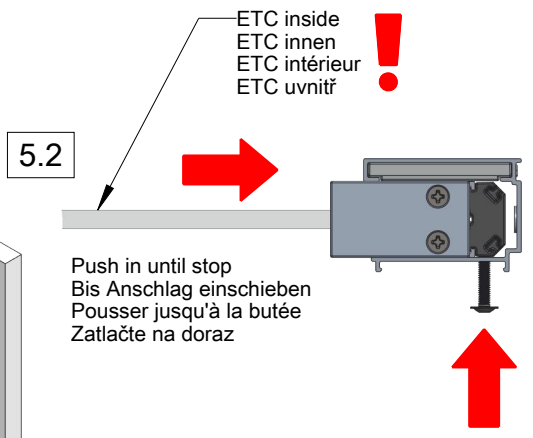
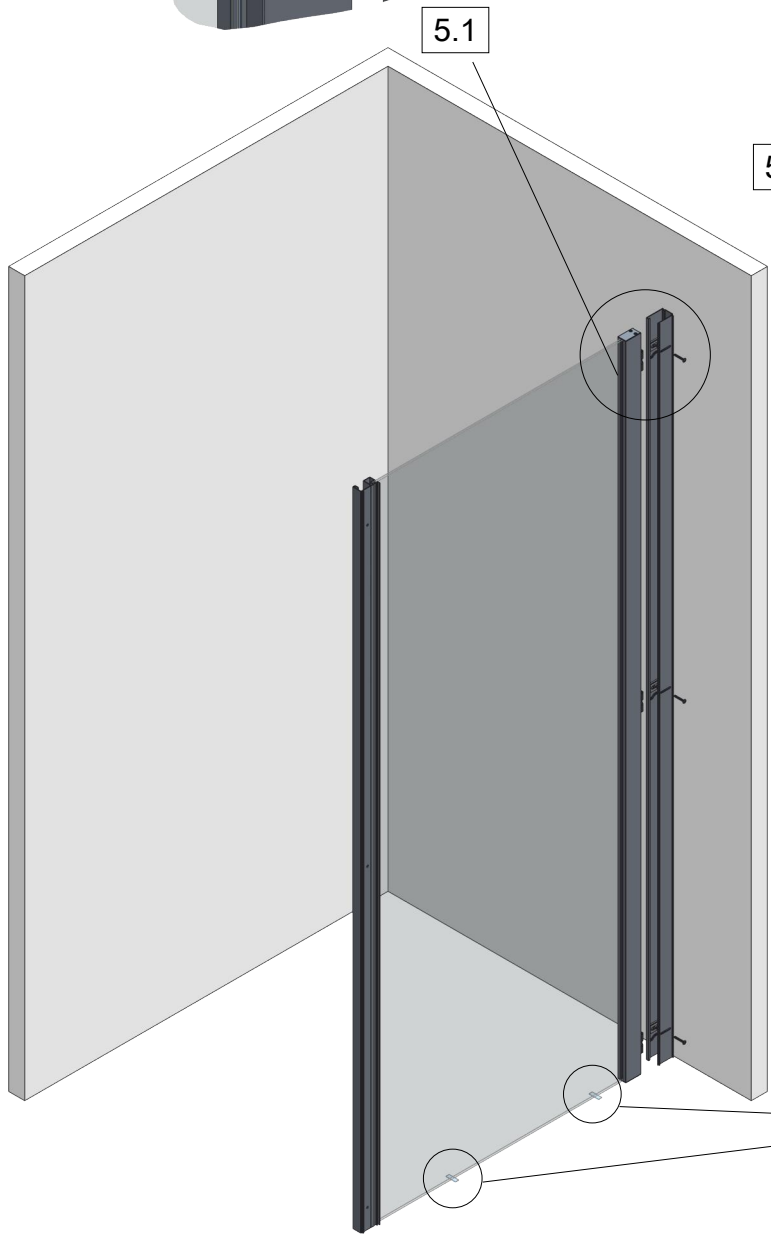
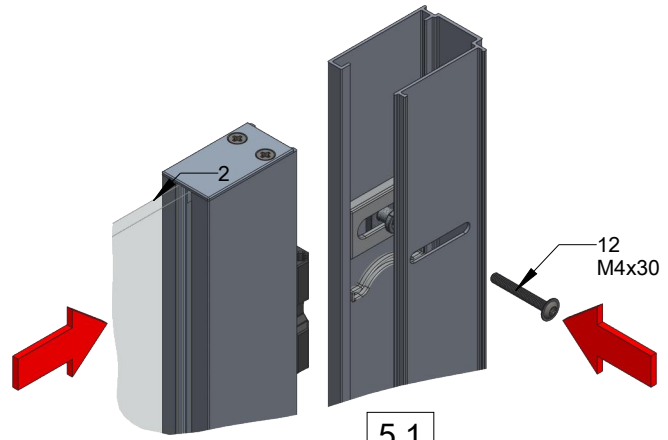
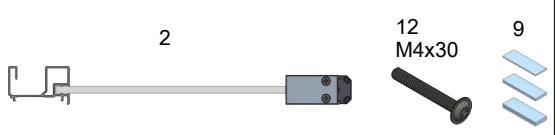

Modification of stabiliser for connecting to fixed element
 Umbau Halterohr für Anschluss an Festelement
 Modification du stabilisateur pour le relia à l'élément fixe
 Úprava stabilizátoru pro připojení k pevnému prvku

Stabiliser from MI FXP
 Halterohr von MI FXP
 Stabilisateur de MI FXP
 Stabilizátor od MI FXP

Stabiliser from fixed element
 Halterohr von Festelement
 Stabilisateur à partir d'un élément fixe
 Stabilizátor z pevného prvku

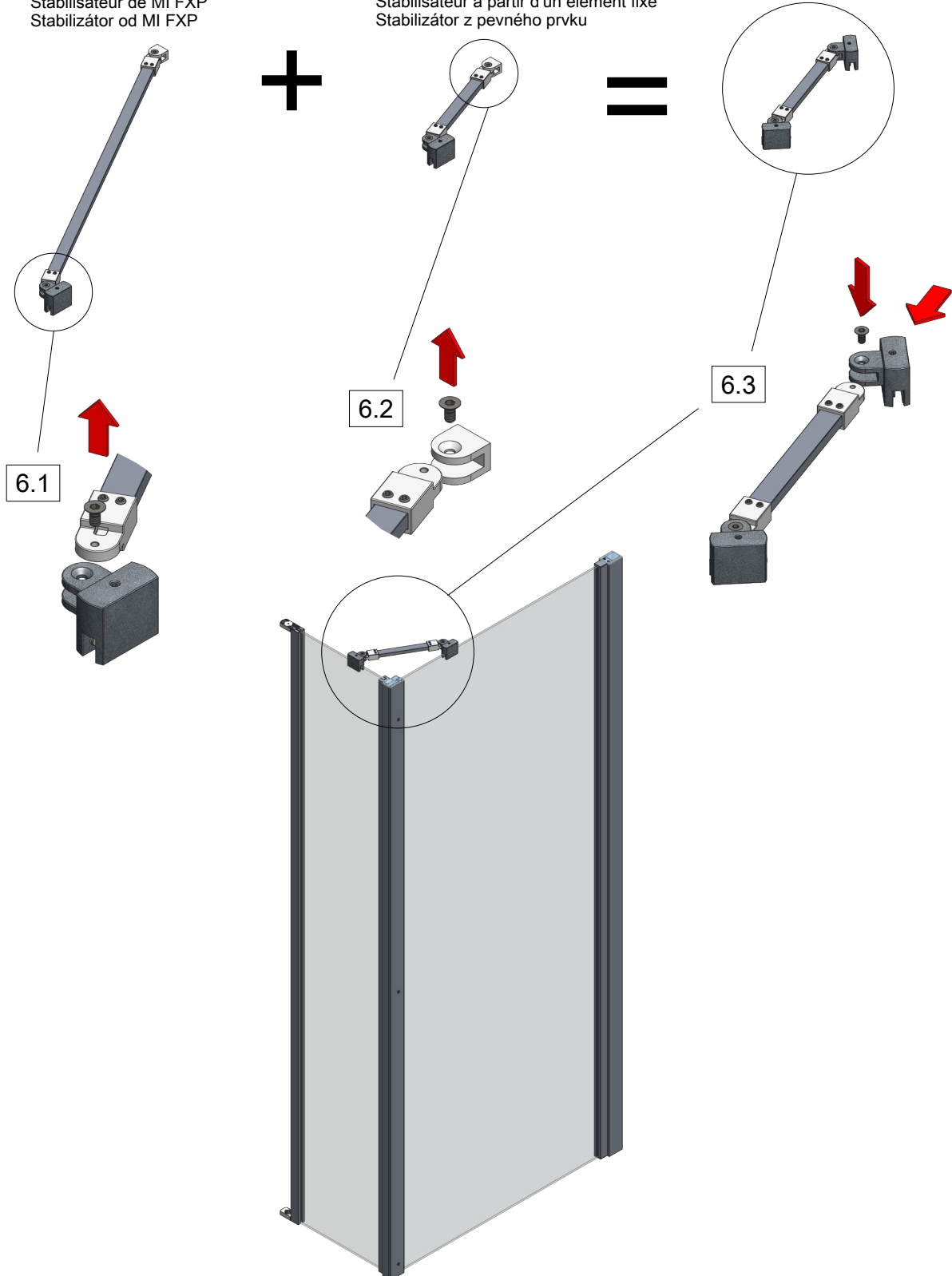

Shortening is possible / Kürzung ist möglich
 Coupe possible / Možnost řezání

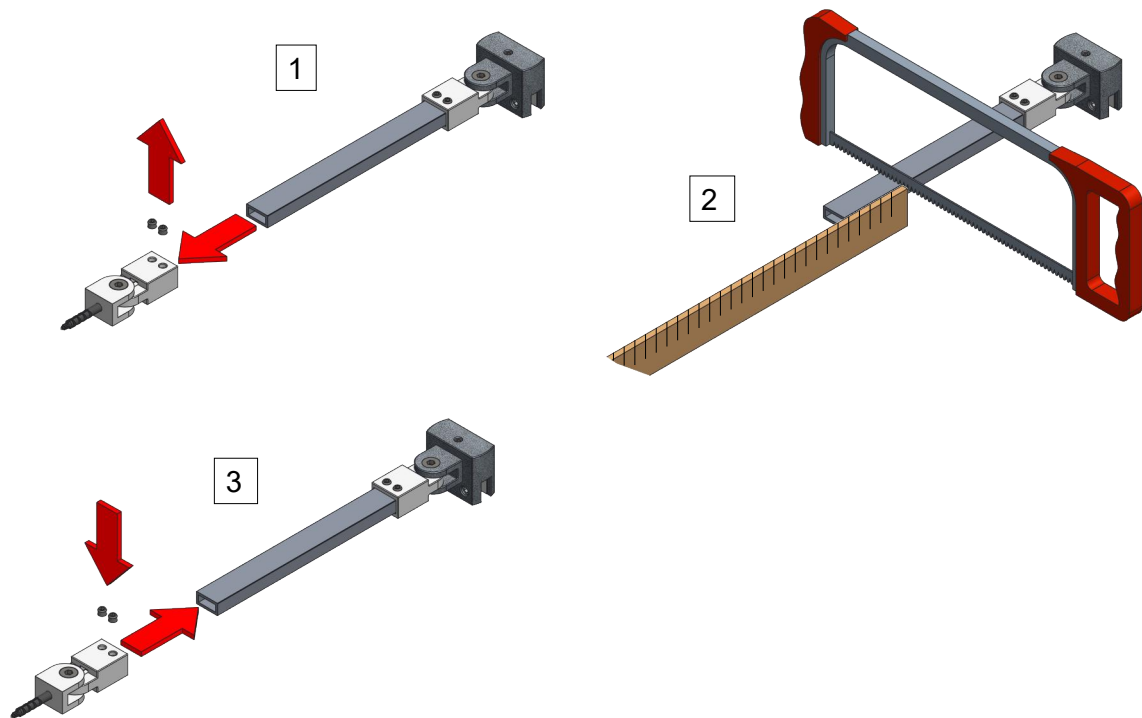

Rotation is possible / Rotation ist möglich
 Rotation possible / Rotace je možná

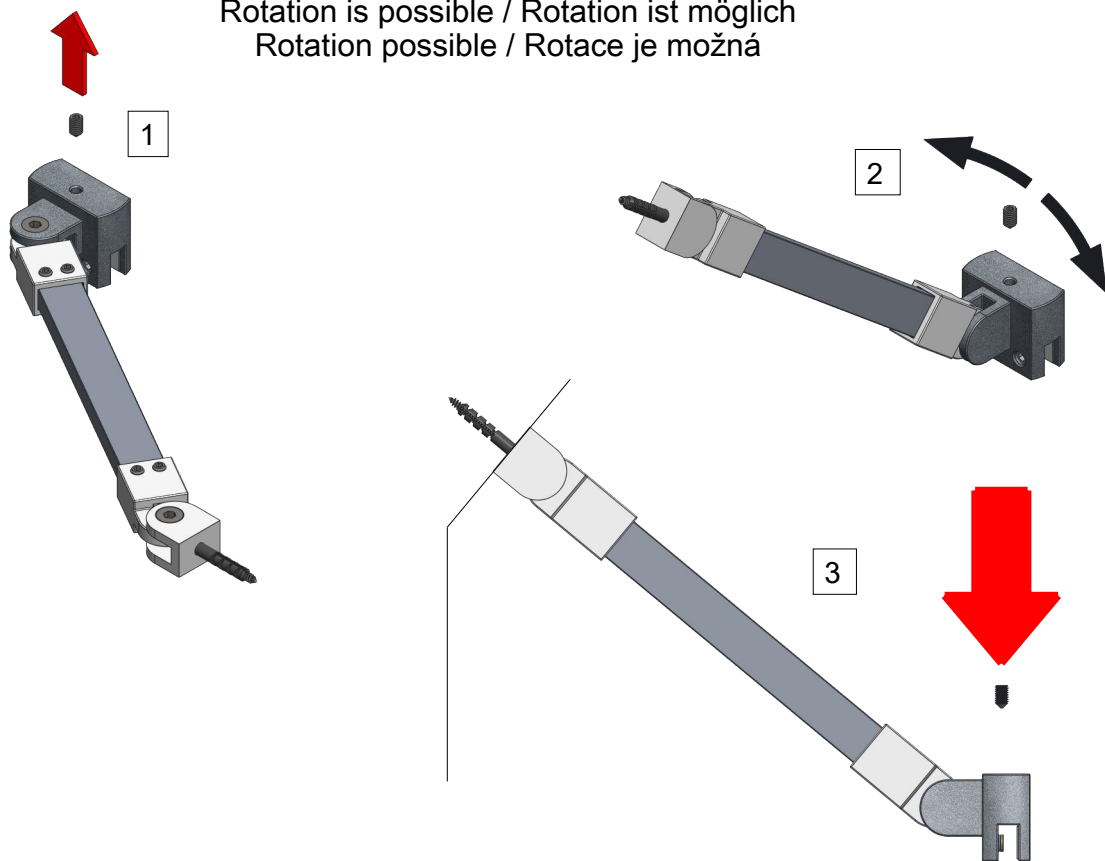

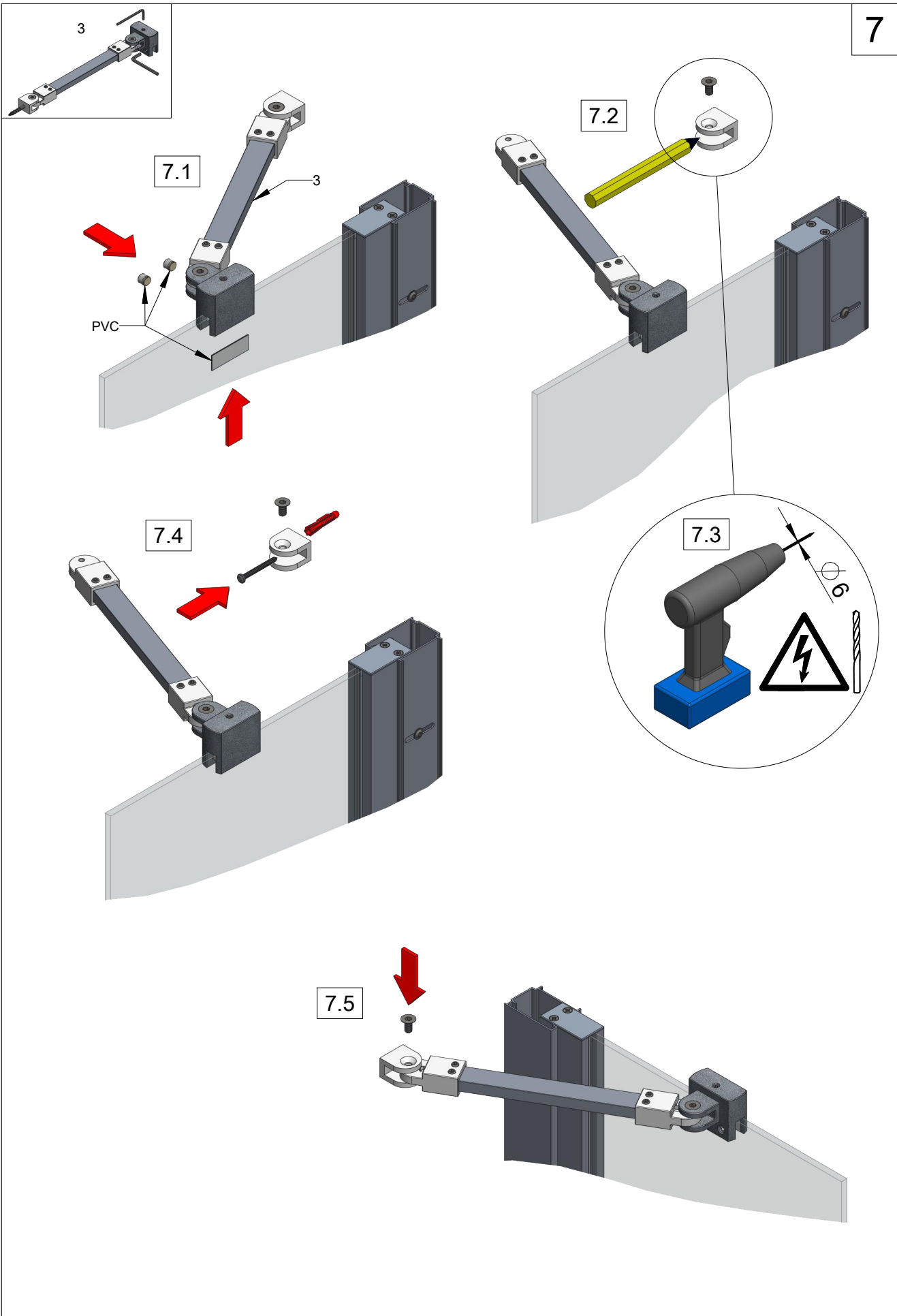

Subject to technical modification! Warranty service only if these instructions are followed.
 Technische Änderungen vorbehalten! Garantieleistung nur bei Beachtung dieser Anweisungen.
 Sous réserve de modifications techniques! Garantie uniquement si ces instructions sont respectées.
 S výhradou technických změn! Záruční servis pouze při dodržení těchto pokynů

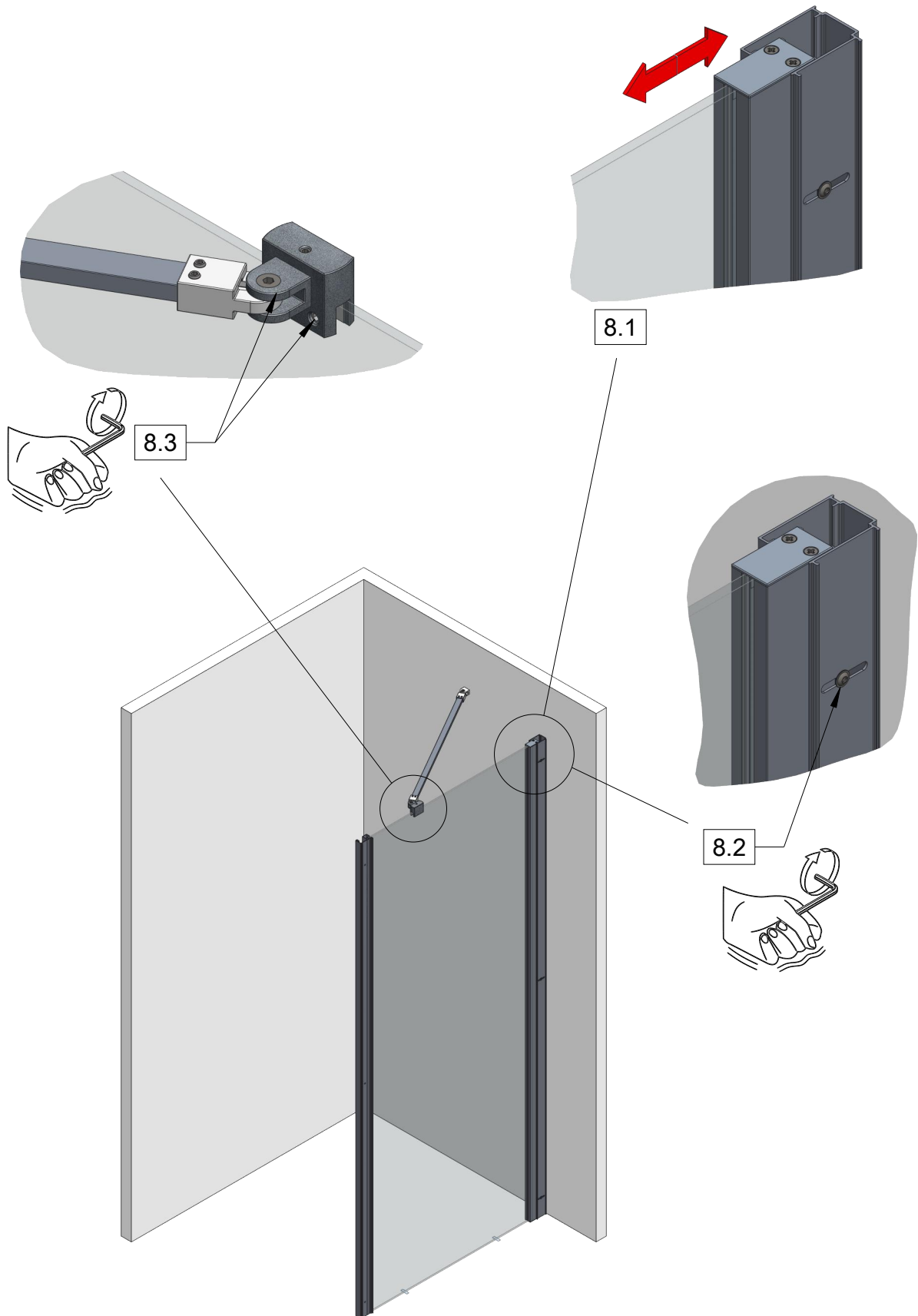

7
M4x12



9

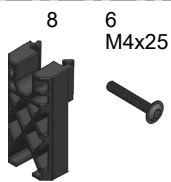
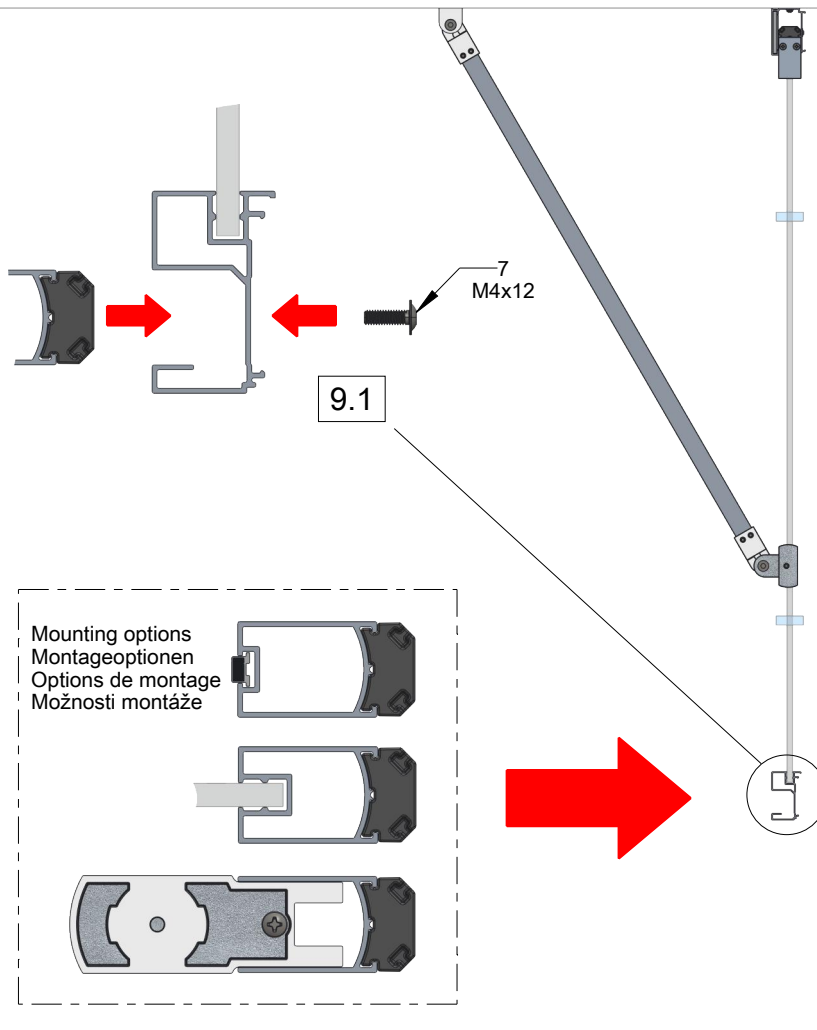

Assembly U-cabin / Montage U-Kabine Montage cabine en U / Montáž U-Kabine

Assembly of a U-Cabin only possible with PIV / PIF
Montage einer U-Kabine nur mit PIV / PIF möglich
L'assemblage d'une cabine en U n'est possible qu'avec PIV / PIF
Montáž kabiny U-Cabin je možná pouze s PIV / PIF

For large setting +25 use adapter no.8
Für die große Einstellung +25 den Adapter Nr.8 verwenden
Pour le grand réglage +25 utiliser l'adaptateur n°8
Pro velké nastavení +25 použijte adaptér č.8

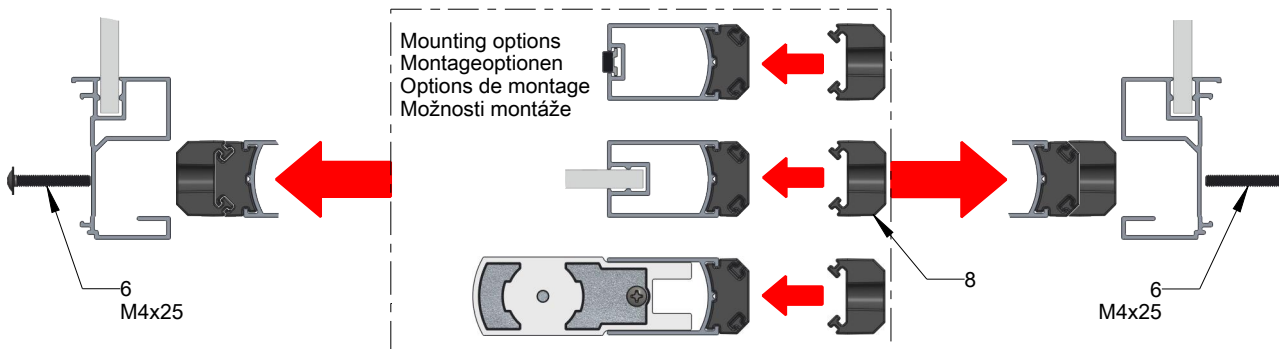

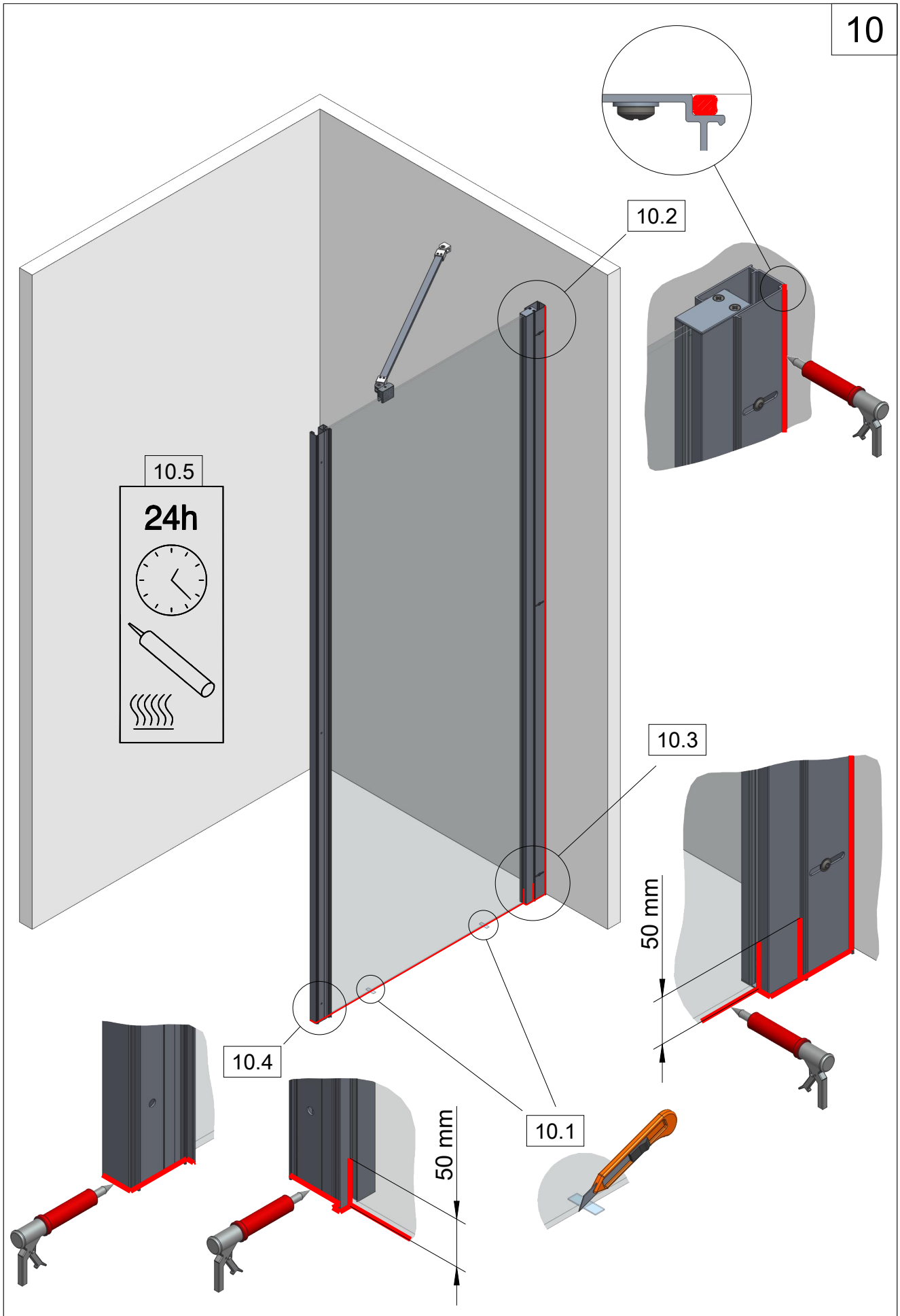

Subject to technical modification! Warranty service only if these instructions are followed.
 Technische Änderungen vorbehalten! Garantieleistung nur bei Beachtung dieser Anweisungen.
 Sous réserve de modifications techniques! Garantie uniquement si ces instructions sont respectées.
 S výhradou technických změn! Záruční servis pouze při dodržení těchto pokynů

1 / 11

4 / 5

16

11

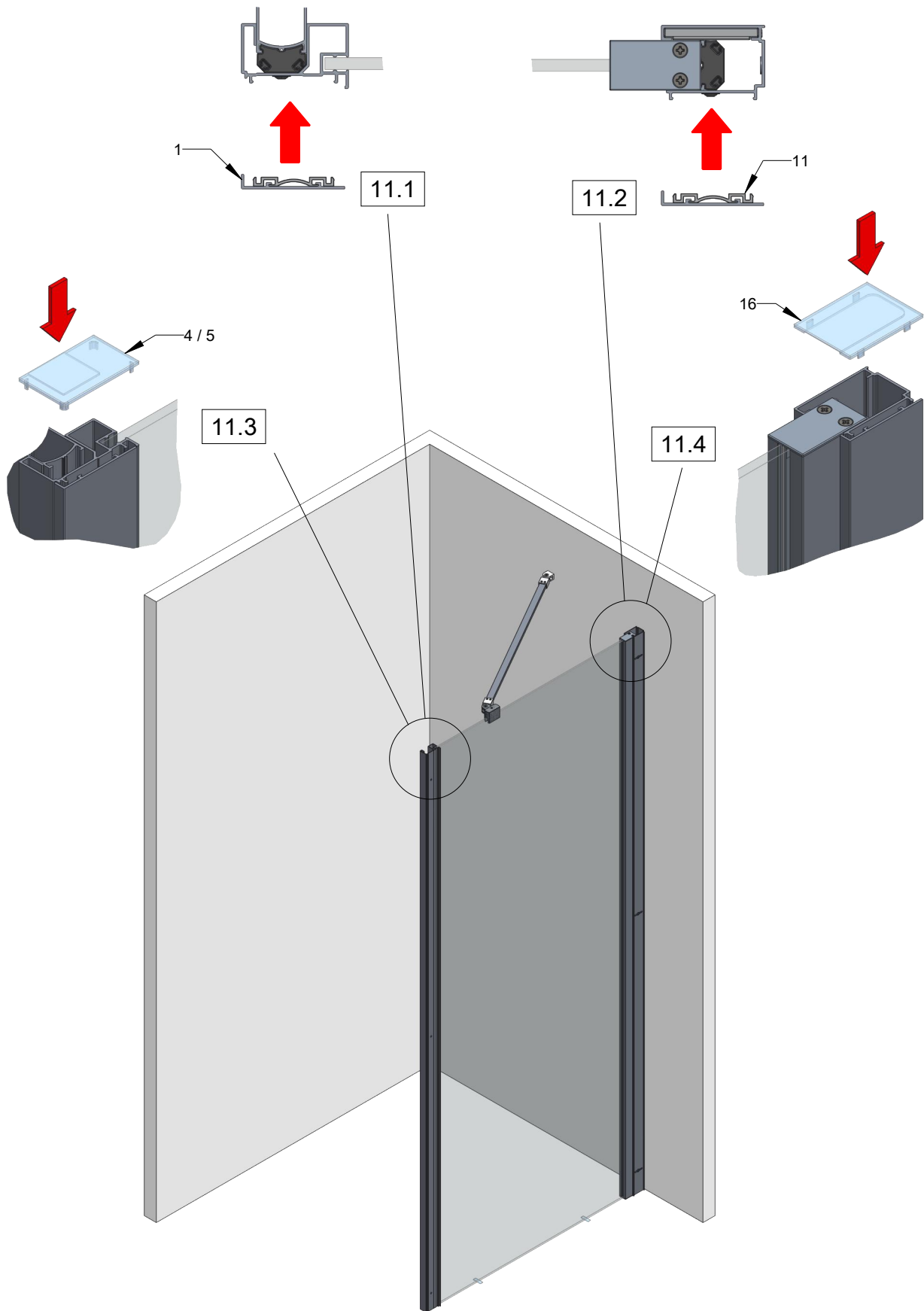
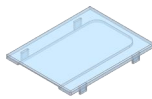
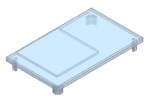

Subject to technical modification! Warranty service only if these instructions are followed.
 Technische Änderungen vorbehalten! Garantieleistung nur bei Beachtung dieser Anweisungen.
 Sous réserve de modifications techniques! Garantie uniquement si ces instructions sont respectées.
 S výhradou technických změn! Záruční servis pouze při dodržení těchto pokynů

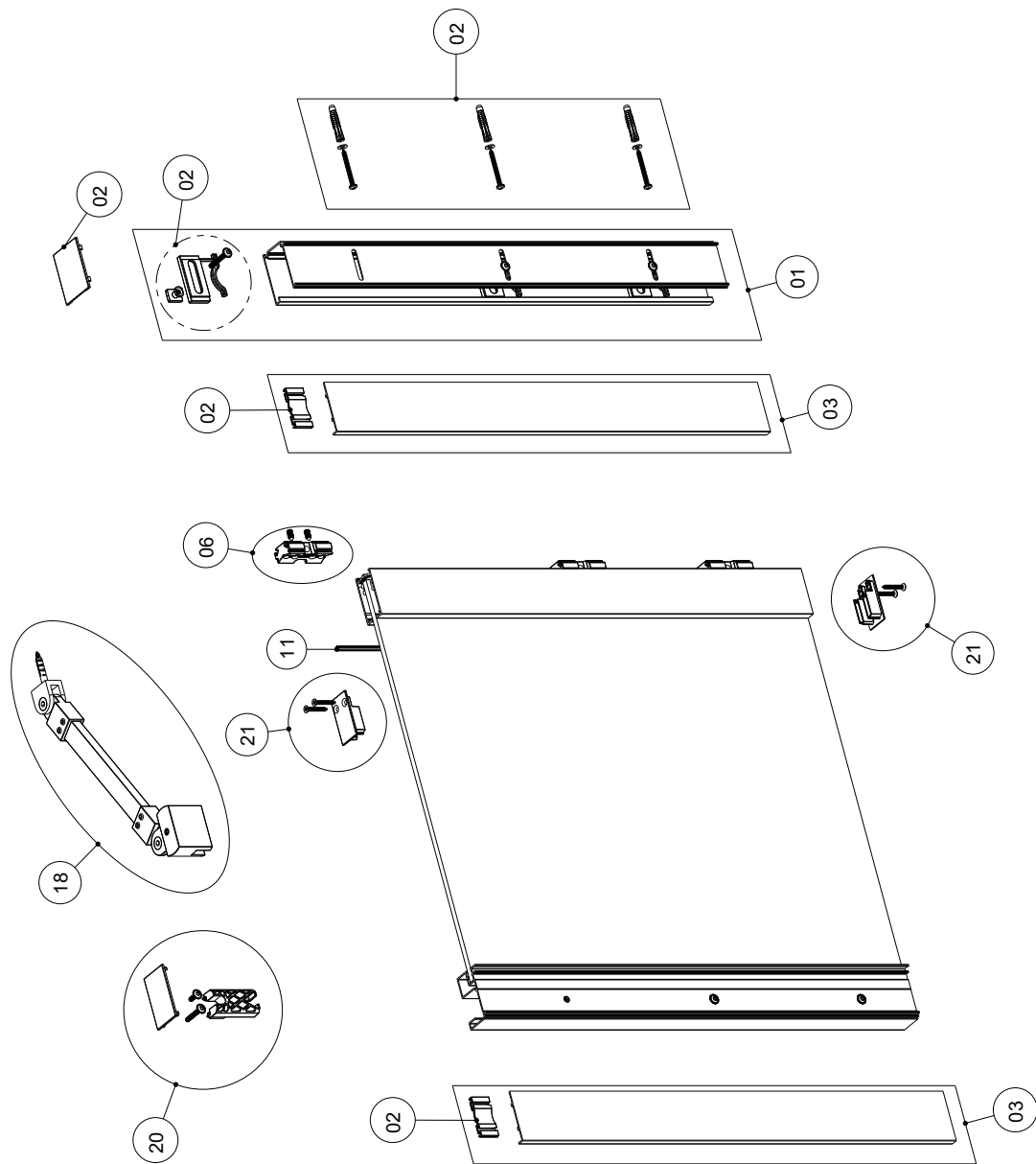

Pos.	Information	Color	Articel number	Serial number
01	different dimensions	silver gloss	---	*
		black matt	---	*
02	---	---	1110001675	---
03	different dimensions	silver gloss	---	*
		black matt	---	*
04	different dimensions	silver gloss	---	*
		black matt	---	*
05	L=2000mm	---	1110001654	---
06	---	---	1110001678	---
07	---	chromed	1110001680	---
		black matt	1110001681	---
08	4 parts	---	1110001664	---
09	different dimensions	silver gloss	---	*
		black matt	---	*
10	---	grey	1110001682	---
		black	1110001683	---
11	L=2000mm	---	1110001655	---
12	L=2000mm	---	1110001651	---
13	L=2000mm	---	1110001653	---
14	different dimensions	silver gloss	---	*
		black matt	---	*
15	L=980mm	---	1110001656	---
16	L=1450mm	chromed	1110001660	---
		black	1110001661	---
17	1 part complete	chromed	1110001665	---
		black	1110001666	---
18	L=190mm	chromed	1110001667	---
		black	1110001671	---
	L=390mm	chromed	1110001668	---
		black	1110001672	---
	L=650mm	chromed	1110001669	---
		black	1110001673	---
	L=850mm	chromed	1110001670	---
		black	1110001674	---
19	2 parts L=2000mm	---	1110001652	---
20	---	---	1110001676	---
21	---	grey	1110001684	---
		black	1110001685	---
22	R=500/550	---	1110001658	---
23	R=500	chromed	1110001662	---
	R=550	chromed	1110001663	---
24	L=2000mm	---	1110001659	---
25	2 parts	---	1110001657	---
26	left hinge	chromed	1110001686	---
		black	1110001687	---
27	righthinge	chromed	1110001688	---
		black	1110001689	---
28	---	---	---	---
29	---	---	---	---
30	---	---	1110001679	---
31	different dimensions	silver gloss	---	*
		black matt	---	*
32	different dimensions	silver gloss	---	*
		black matt	---	*

* Specification of serial number required / * Angabe der Seriennummer erforderlich
 * Indication du numéro de série nécessaire / * Nezbytné uvedení sériového čísla



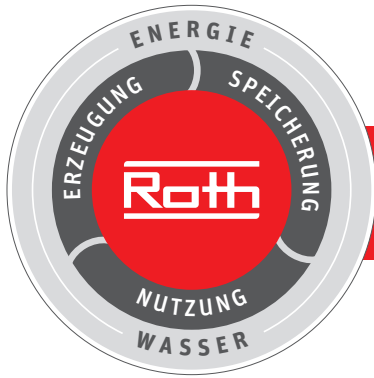

Roth Energie- und Sanitärsysteme

All image-, product-, dimensional- and design data
correspond to the day of printing

Sämtliche Bild-, Produkt-, Maß- und Ausführungsangaben entsprechen
dem Tag der Drucklegung.

Toutes les données relatives aux images, aux produits, aux
dimensions et à l'exécution sont fournies à la date de publication correspondent au jour de
l'impression.

Všechny informace o obrázcích, produktech, rozměrech a designu odpovídají dni tisku.