

Sanitärsysteme

Roth Melina MI PIF

Roth

GB

D

F

CZ

Assembly instructions
Montageanleitung
Notice de montage
Montážní návod



Leben voller Energie

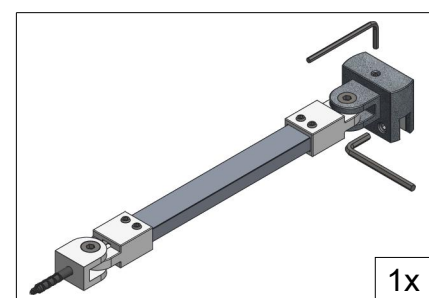
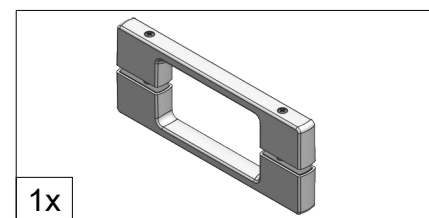
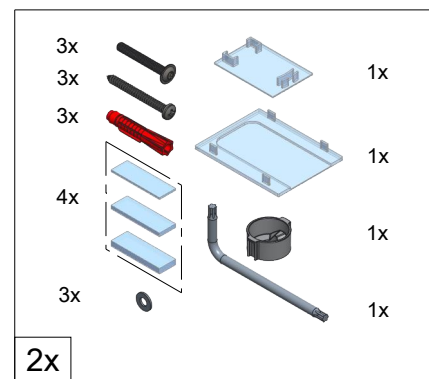
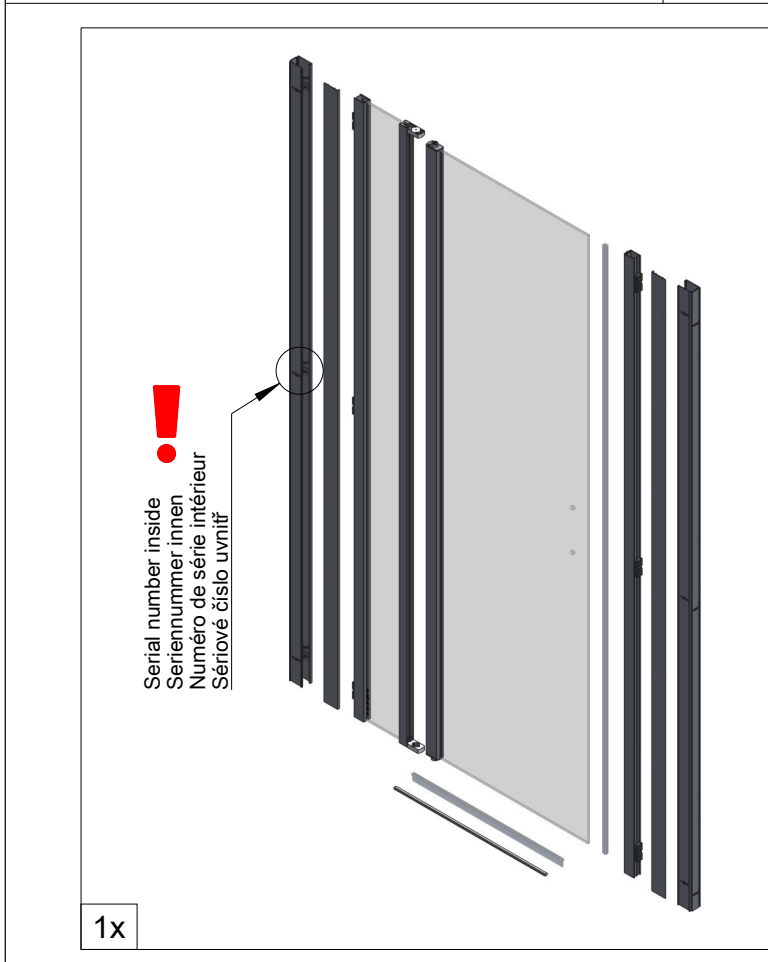
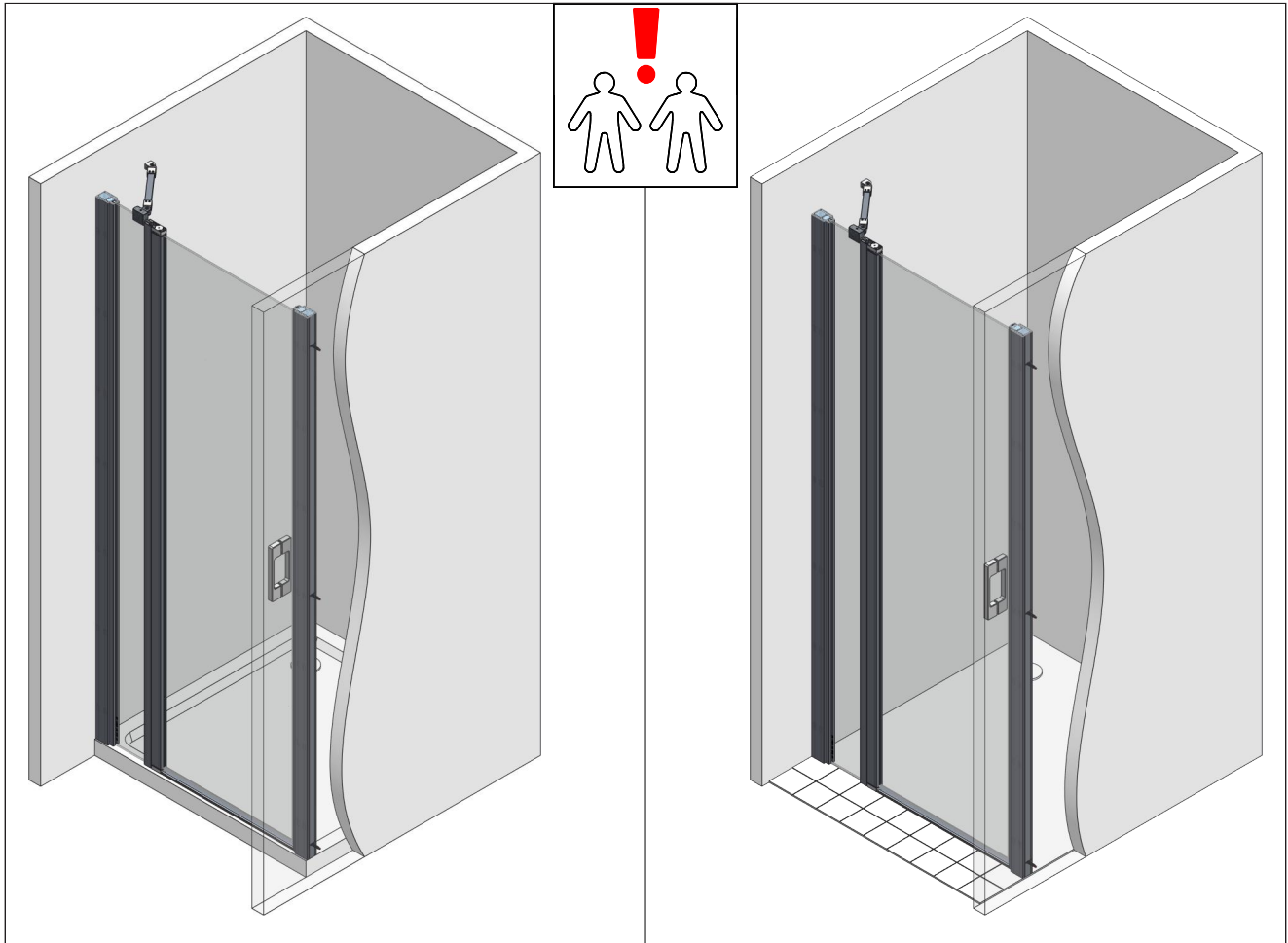

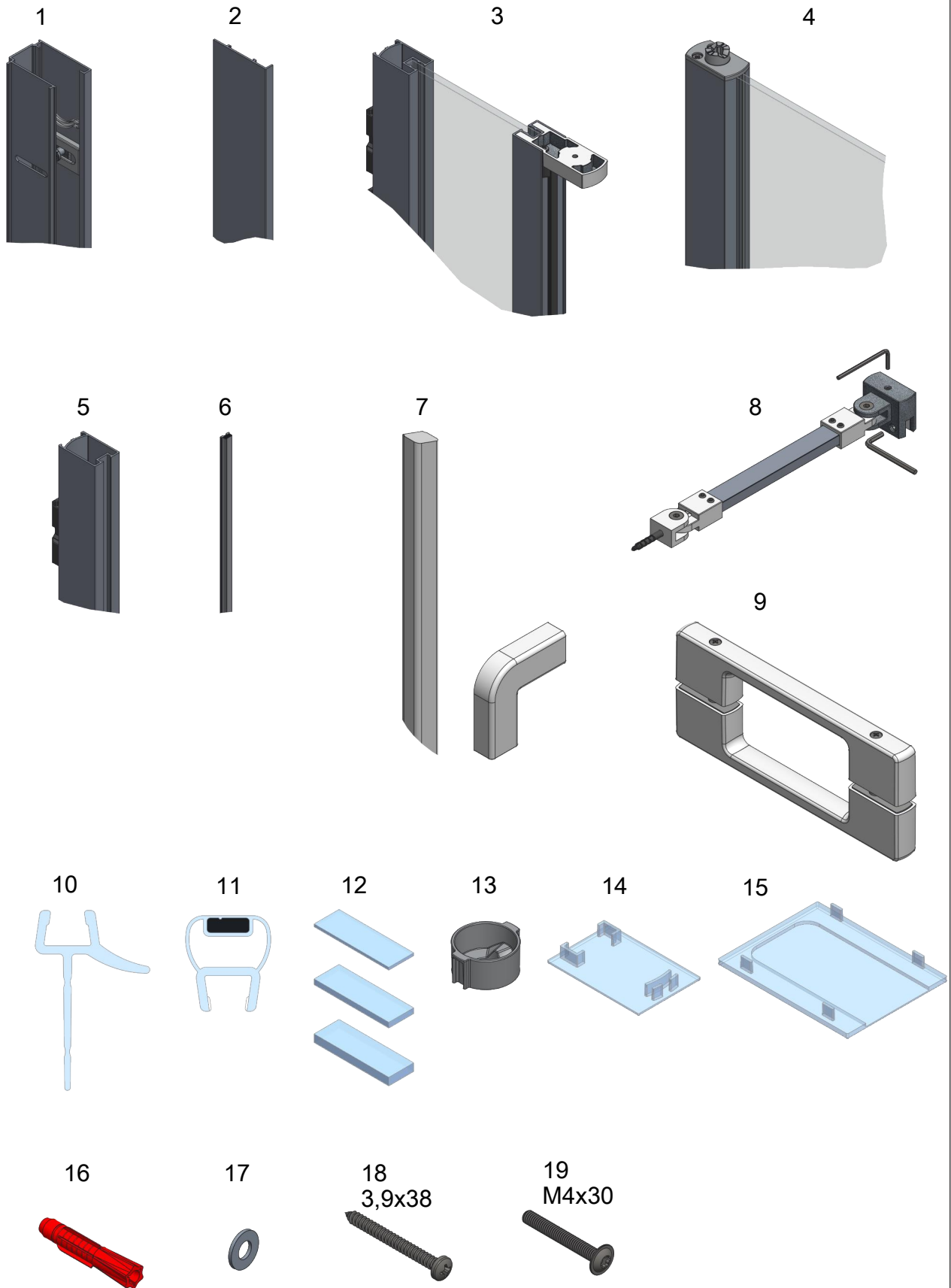

Modification delivery condition (small) to large setting (+25mm)
Umbau Auslieferungszustand (klein) auf große Einstellung (+25mm)
Modification de l'état de livraison (petit) en grand réglage (+25mm)
Úprava dodací podmínky (malá) na velké nastavení (+25 mm)

Delivery condition / Auslieferungszustand
État à la livraison / Stav při dodání



Modification +25 mm / Umbau +25mm
Modification +25mm / Modifikace +25mm

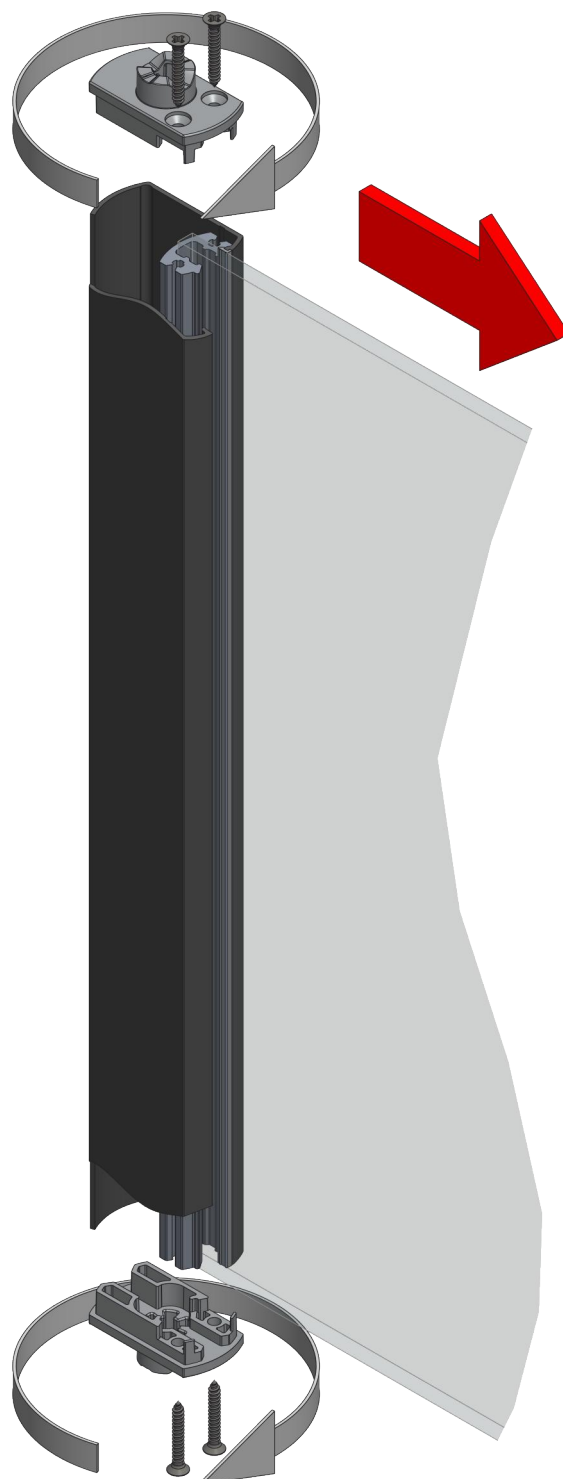

MI PIF

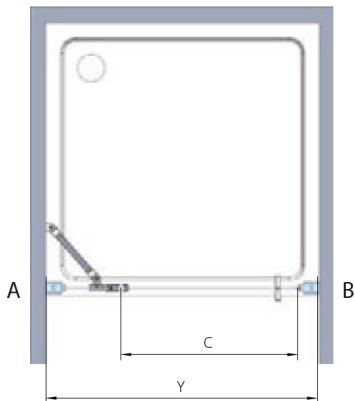

B

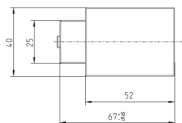

A

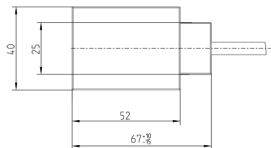

Stav při dodání

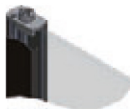

Modifikace +25 mm



Varianta	Y (mm)	C (mm)
800	770-845	459/484
900	870-945	559/584
1000	970-1045	659/684
1100	1070-1145	709/734
1200	1170-1245	759/784

Rozměry včetně modifikace +25 mm

Mounting on shower tray / Montage auf Duschwanne
 Montage sur receveur de douche / Montáž na sprchovou vaničku

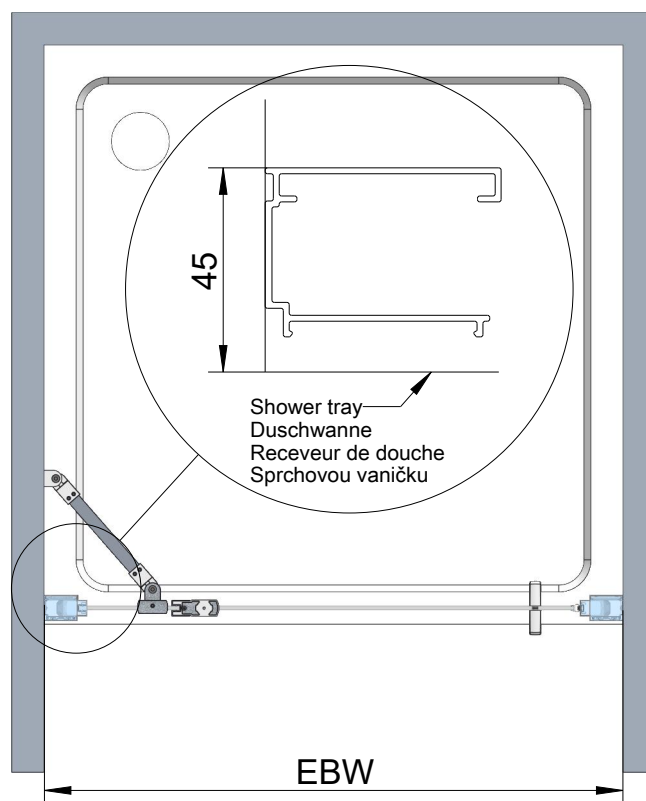

Delivery condition / Auslieferungszustand
 État à la livraison / Stav při dodání

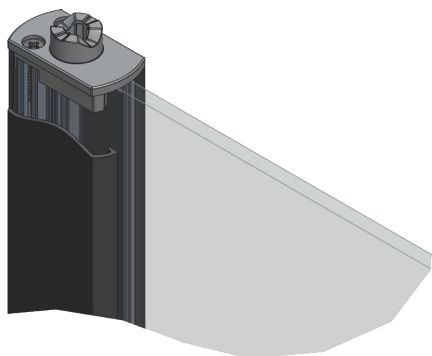

Modification +25 mm / Umbau +25mm
 Modification +25mm / Modifikace +25mm

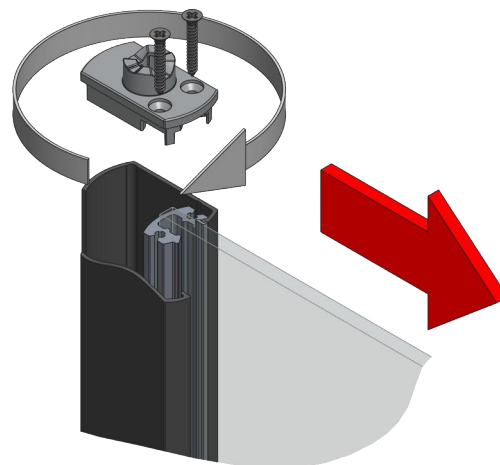

MI PIF	EBW	EBW +25
080	770 - 820	795 - 845
085	820 - 870	845 - 895
090	870 - 920	895 - 945
095	920 - 970	945 - 995
100	970 - 1020	995 - 1045
105	1020 - 1070	1045 - 1095
110	1070 - 1120	1095 - 1145
115	1120 - 1170	1145 - 1195
120	1170 - 1220	1195 - 1245
125	1220 - 1270	1245 - 1295
130	1270-1320	1295-1345

Mounting on floor / Montage auf Boden
 Montage au sol / Montáž na podlahu

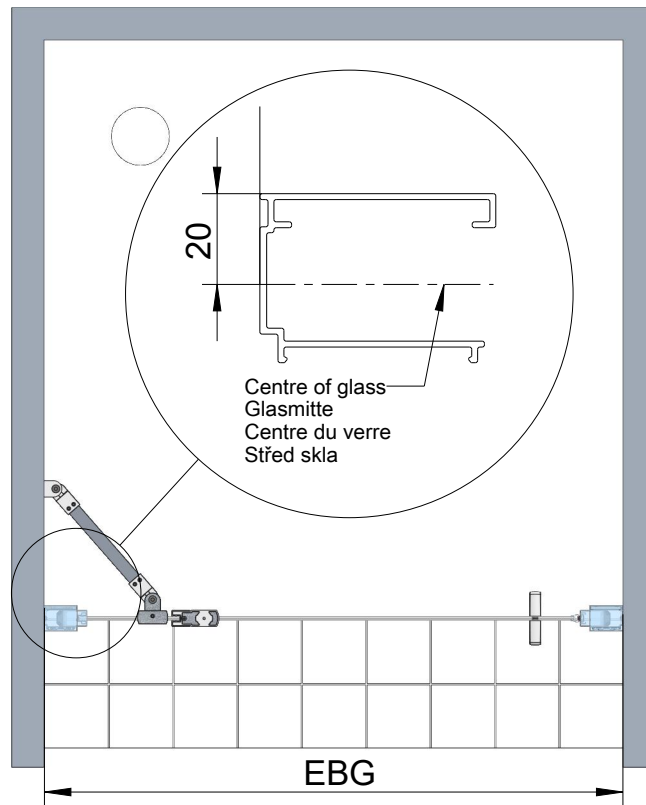

Delivery condition / Auslieferungszustand
 État à la livraison / Stav při dodání

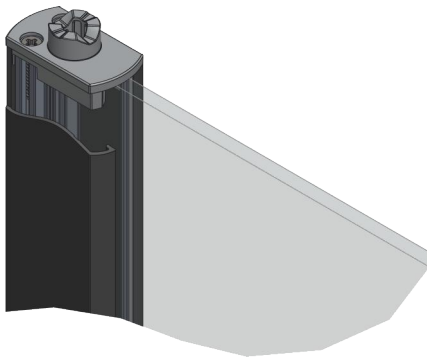

Modification +25 mm / Umbau +25mm
 Modification +25mm / Modifikace +25mm

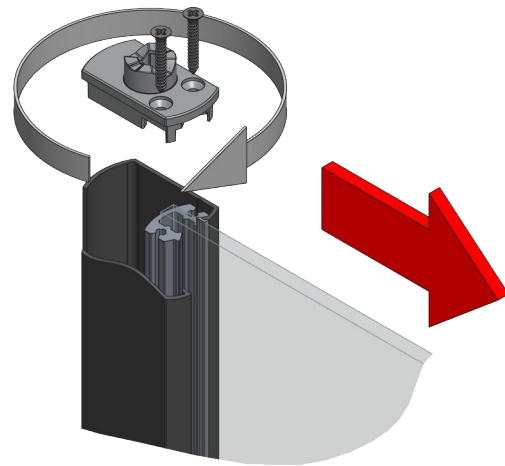

MI PIF	EBG	EBG +25
080	770 - 820	795 - 845
085	820 - 870	845 - 895
090	870 - 920	895 - 945
095	920 - 970	945 - 995
100	970 - 1020	995 - 1045
105	1020 - 1070	1045 - 1095
110	1070 - 1120	1095 - 1145
115	1120 - 1170	1145 - 1195
120	1170 - 1220	1195 - 1245
125	1220 - 1270	1245 - 1295
130	1270 - 1320	1295 - 1345

Subject to technical modification! Warranty service only if these instructions are followed.
 Technische Änderungen vorbehalten! Garantieleistung nur bei Beachtung dieser Anweisungen.
 Sous réserve de modifications techniques! Garantie uniquement si ces instructions sont respectées.
 S výhradou technických změn! Záruční servis pouze při dodržení těchto pokynů

1

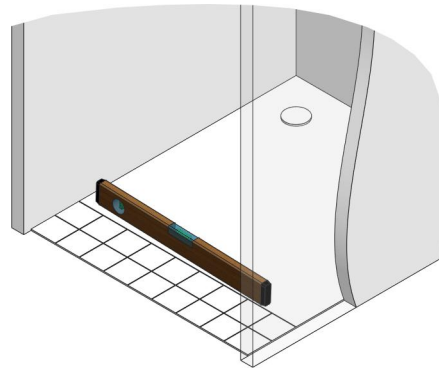
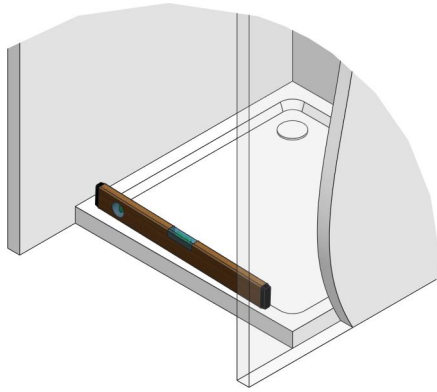

Floor level max. ± 5 mm / Bodenniveau max. ± 5 mm / Niveau du sol max. ± 5 mm / Úroveň podlahy max. ± 5 mm

2

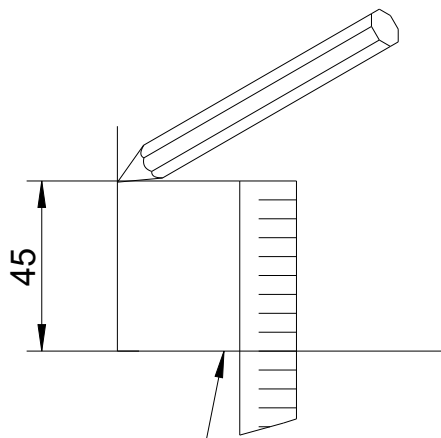

Installation dimension shower tray
Einbaumaß Duschwanne
Dimension de montage du receveur de douche
Instalační rozměr sprchové vaničky

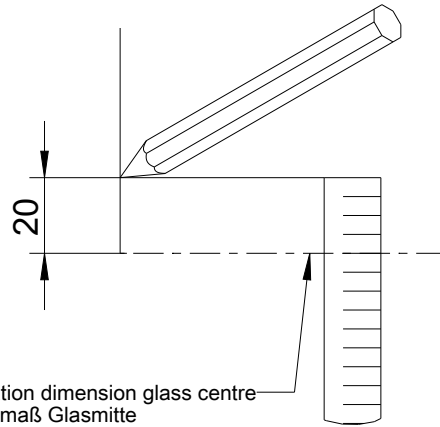

Installation dimension glass centre
Einbaumaß Glasmitte
Dimension de montage centre du verre
Instalační rozměr skleněného středu

3

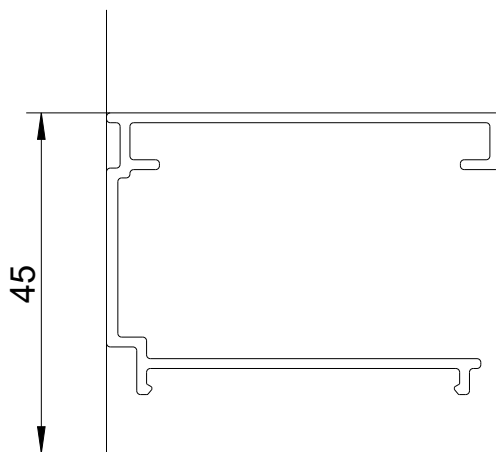

Shower tray
Duschwanne
Receveur de douche
Sprchovou vaničku

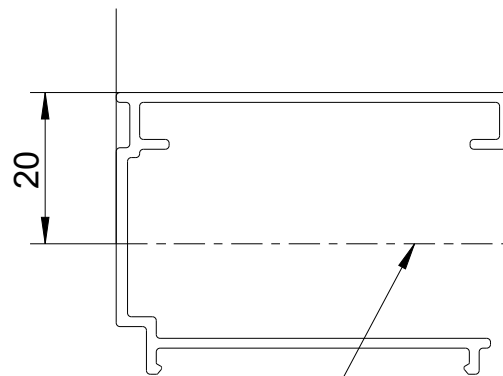

Centre of glass
Glasmitte
Centre du verre
Střed skla

- 16 
- 1 
- 17 
- 18  3,9x38

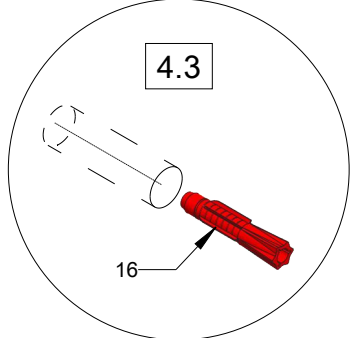
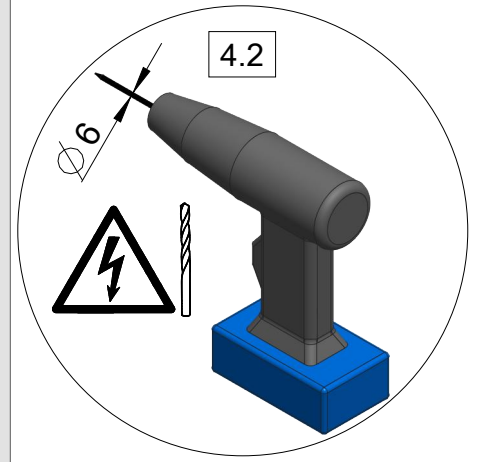
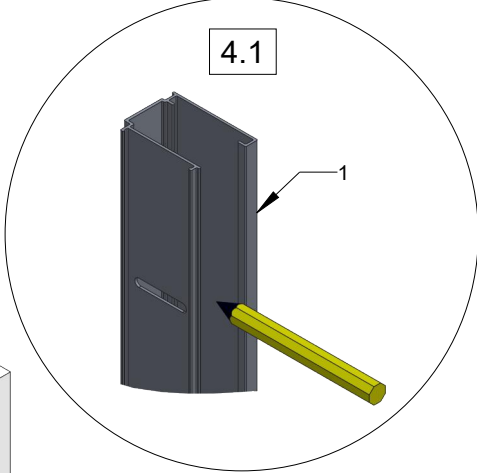
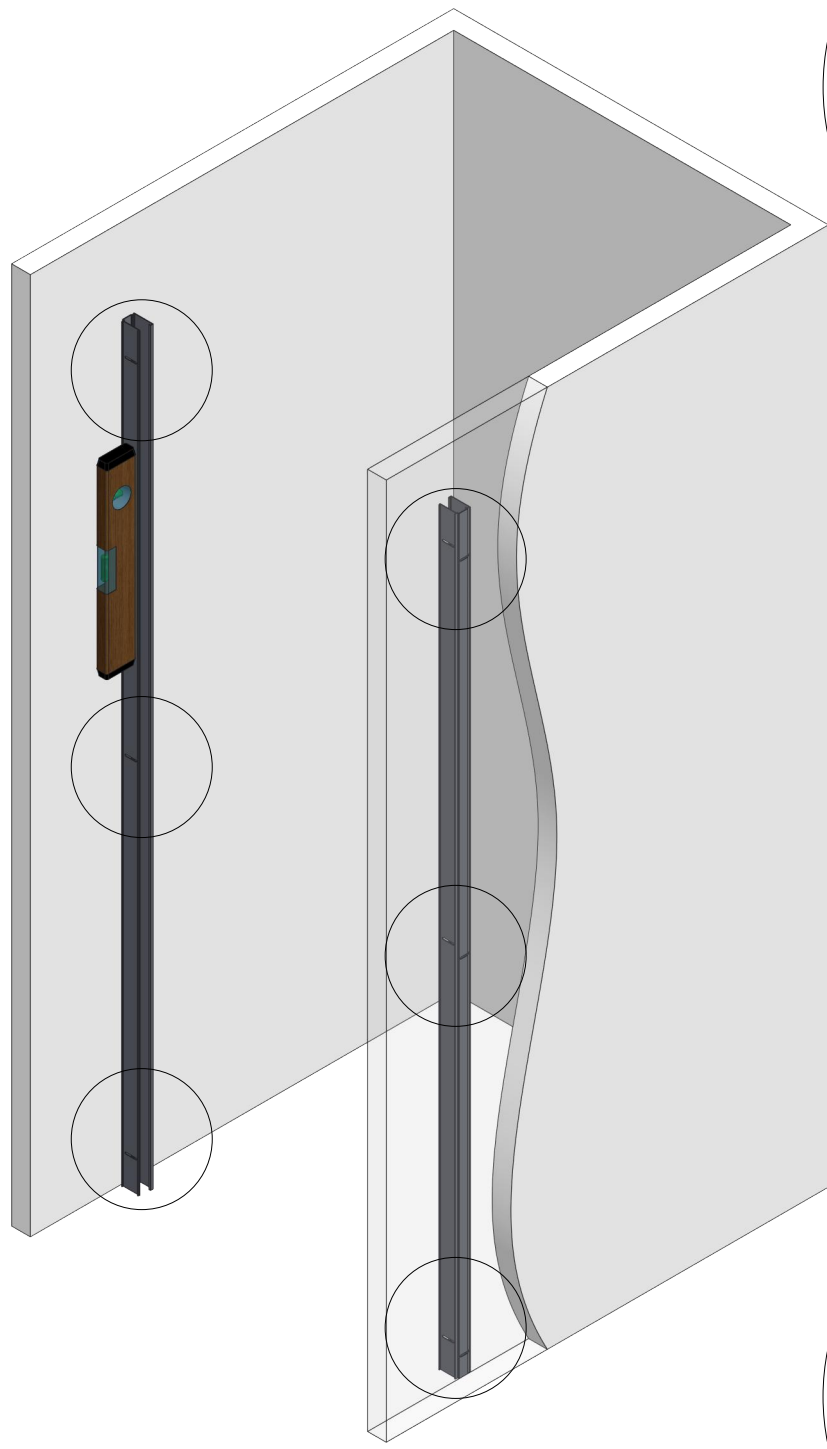

Subject to technical modification! Warranty service only if these instructions are followed.
 Technische Änderungen vorbehalten! Garantieleistung nur bei Beachtung dieser Anweisungen.
 Sous réserve de modifications techniques! Garantie uniquement si ces instructions sont respectées.
 S výhradou technických změn! Záruční servis pouze při dodržení těchto pokynů

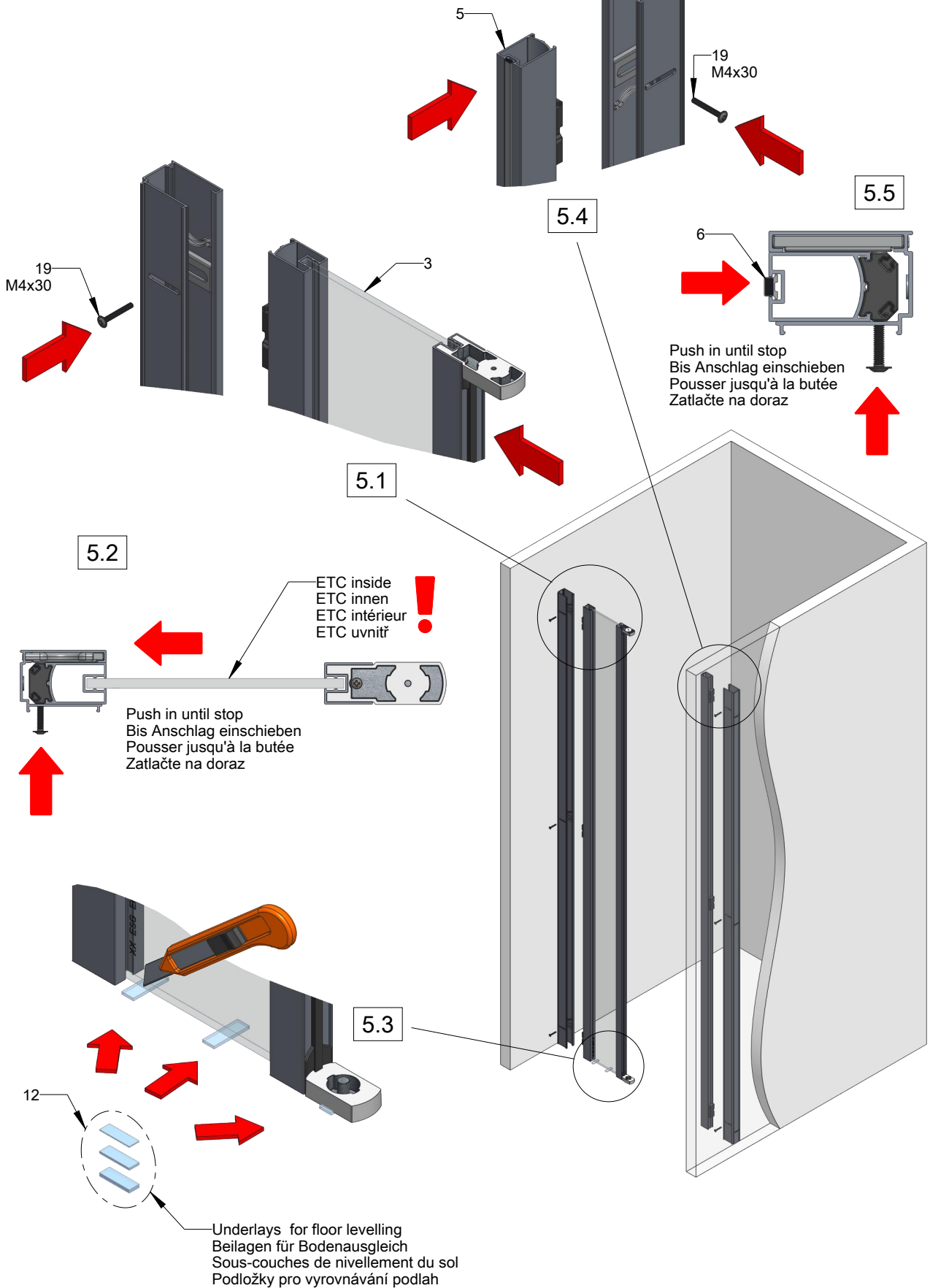
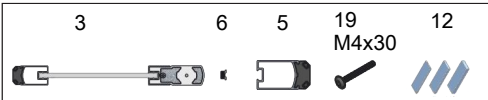

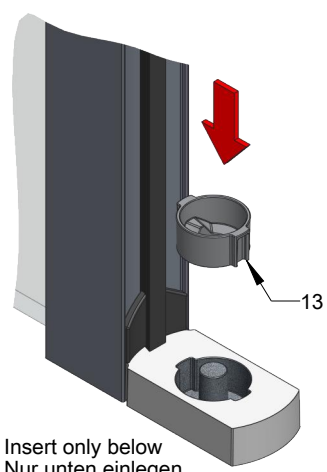
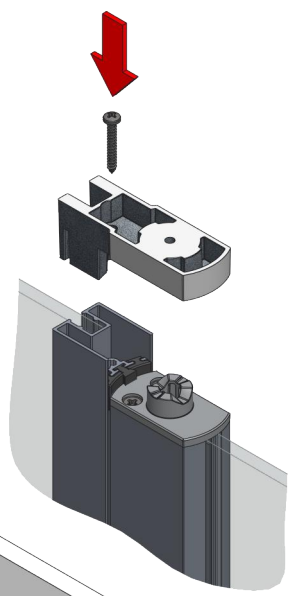
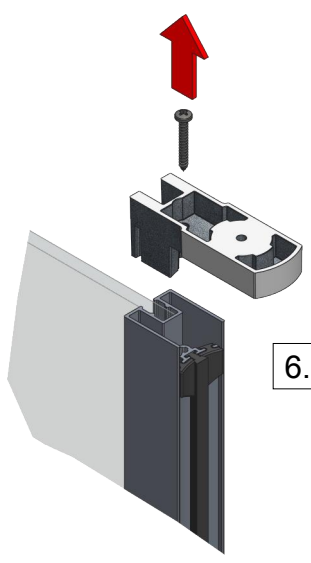

! Insert only below
 Nur unten einlegen
 Insérer uniquement ci-dessous
 ● Vložte pouze níže

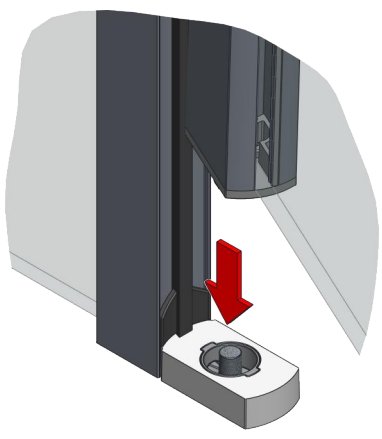
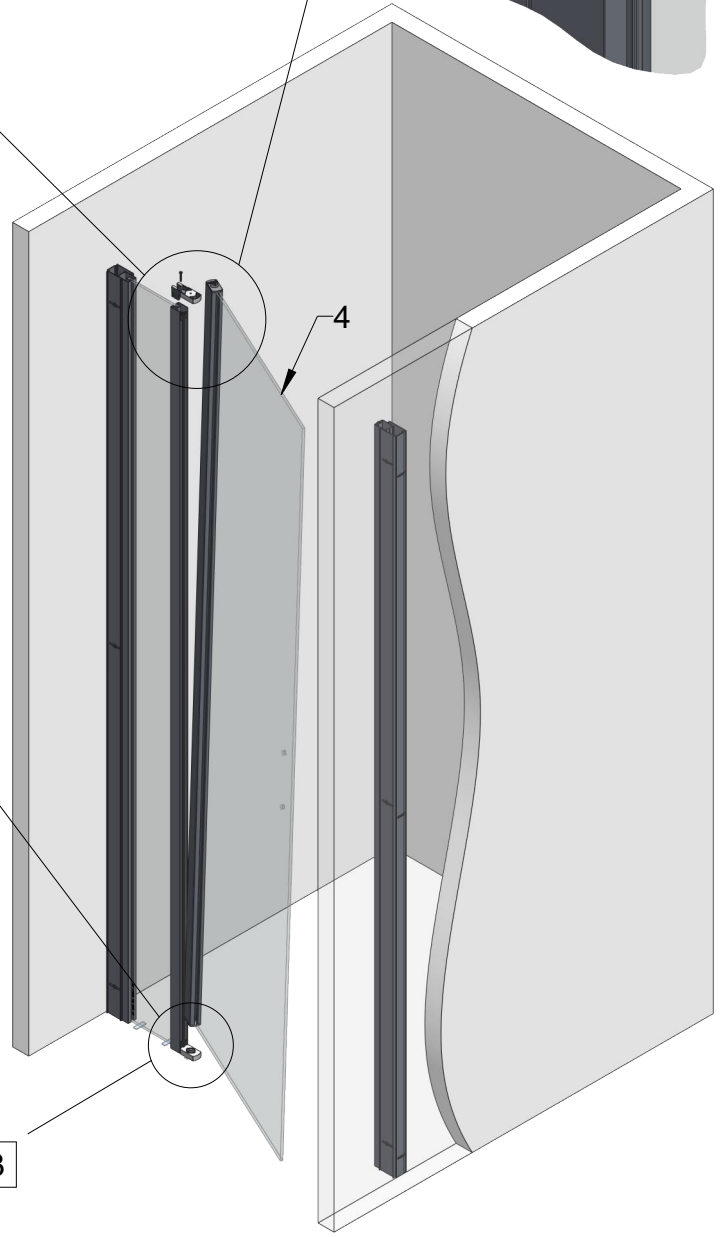

7

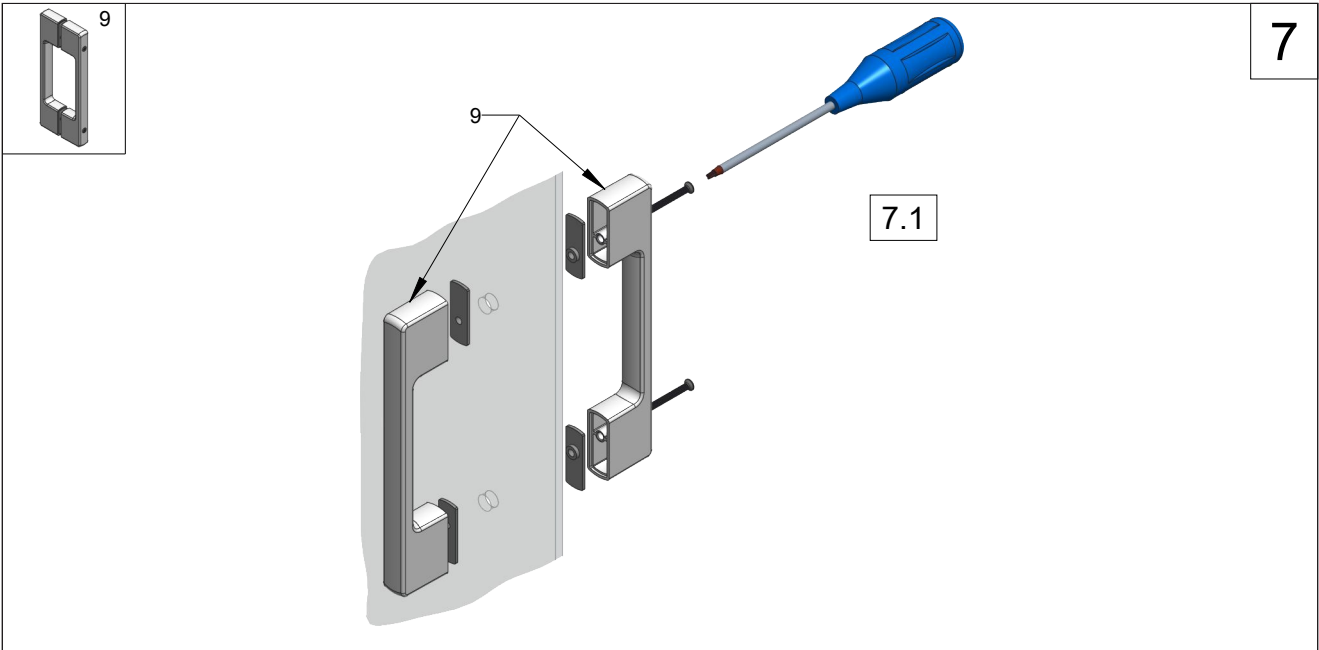

8

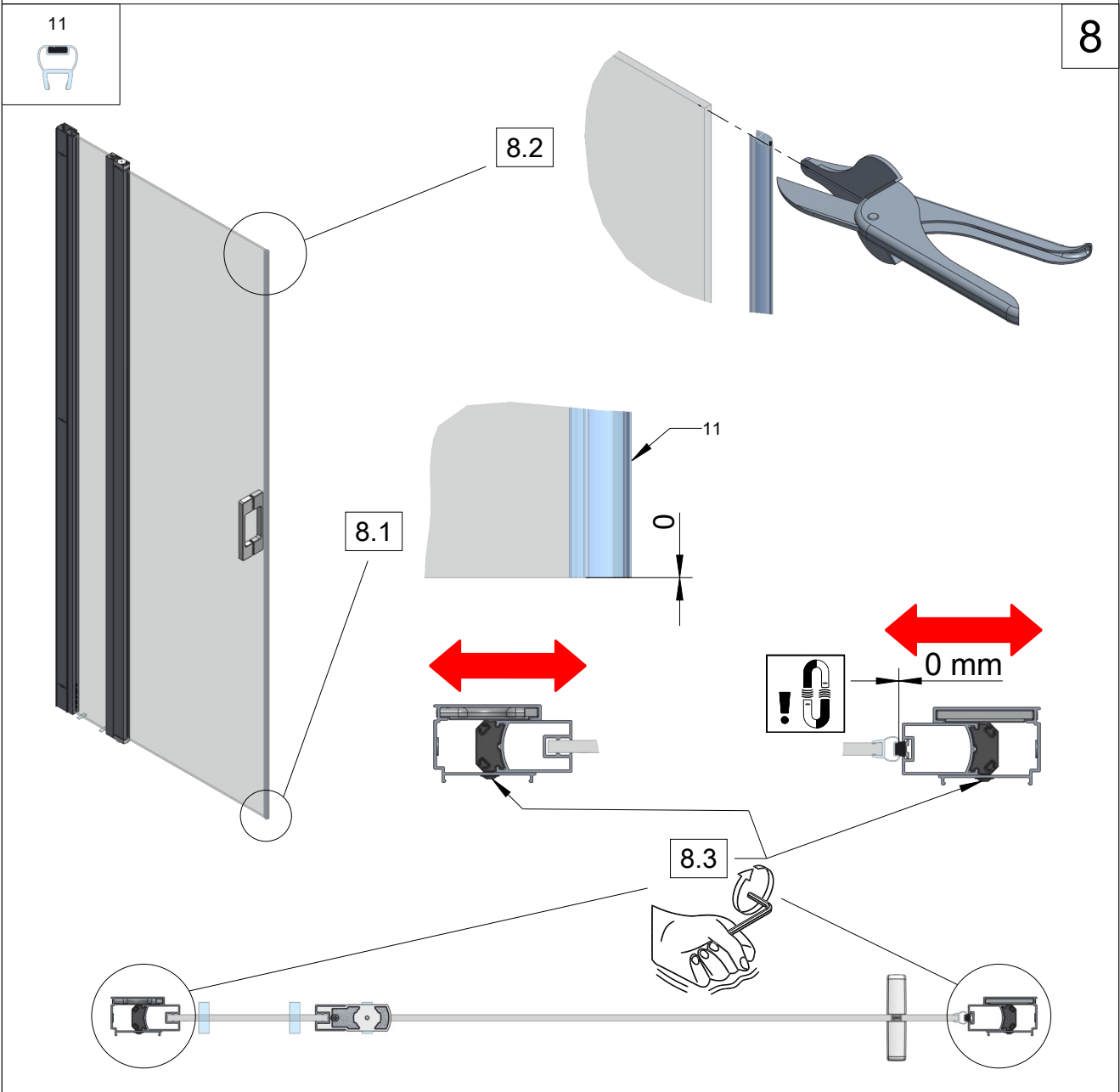

Shortening is possible / Kürzung ist möglich
Coupe possible / Možnost řezání

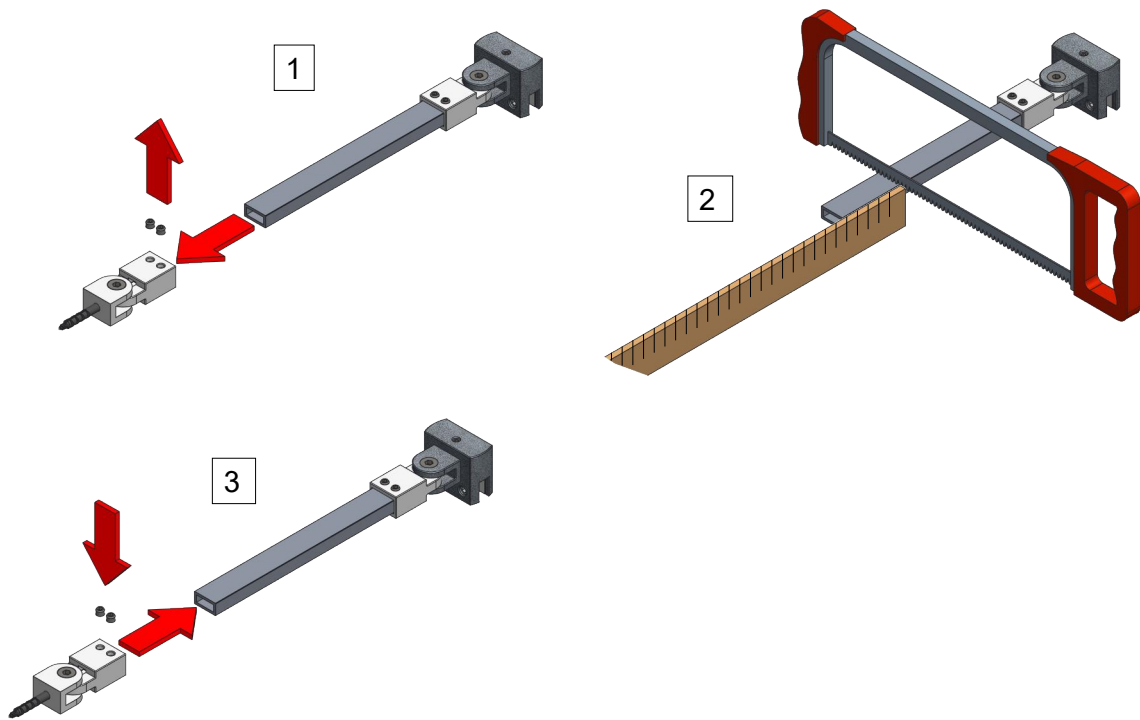

Rotation is possible / Rotation ist möglich
Rotation possible / Rotace je možná

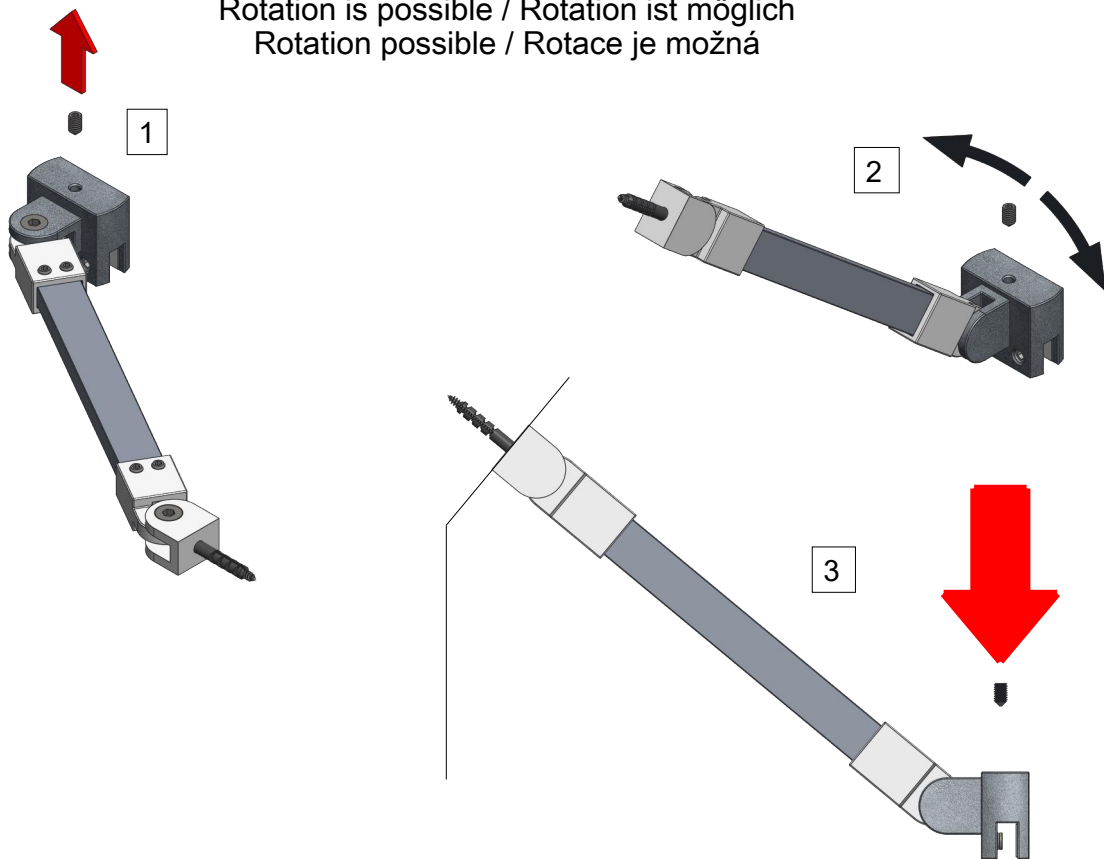

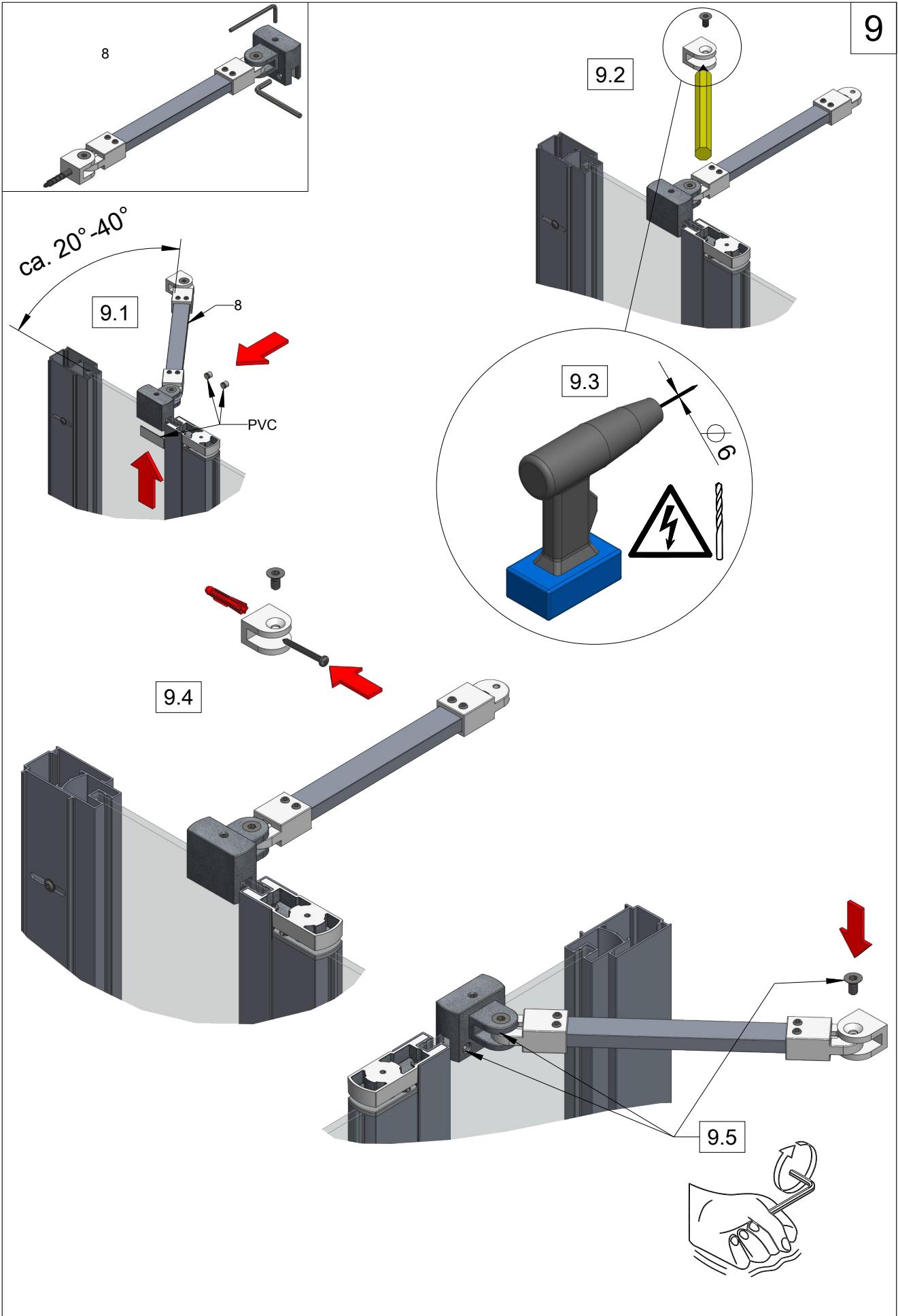

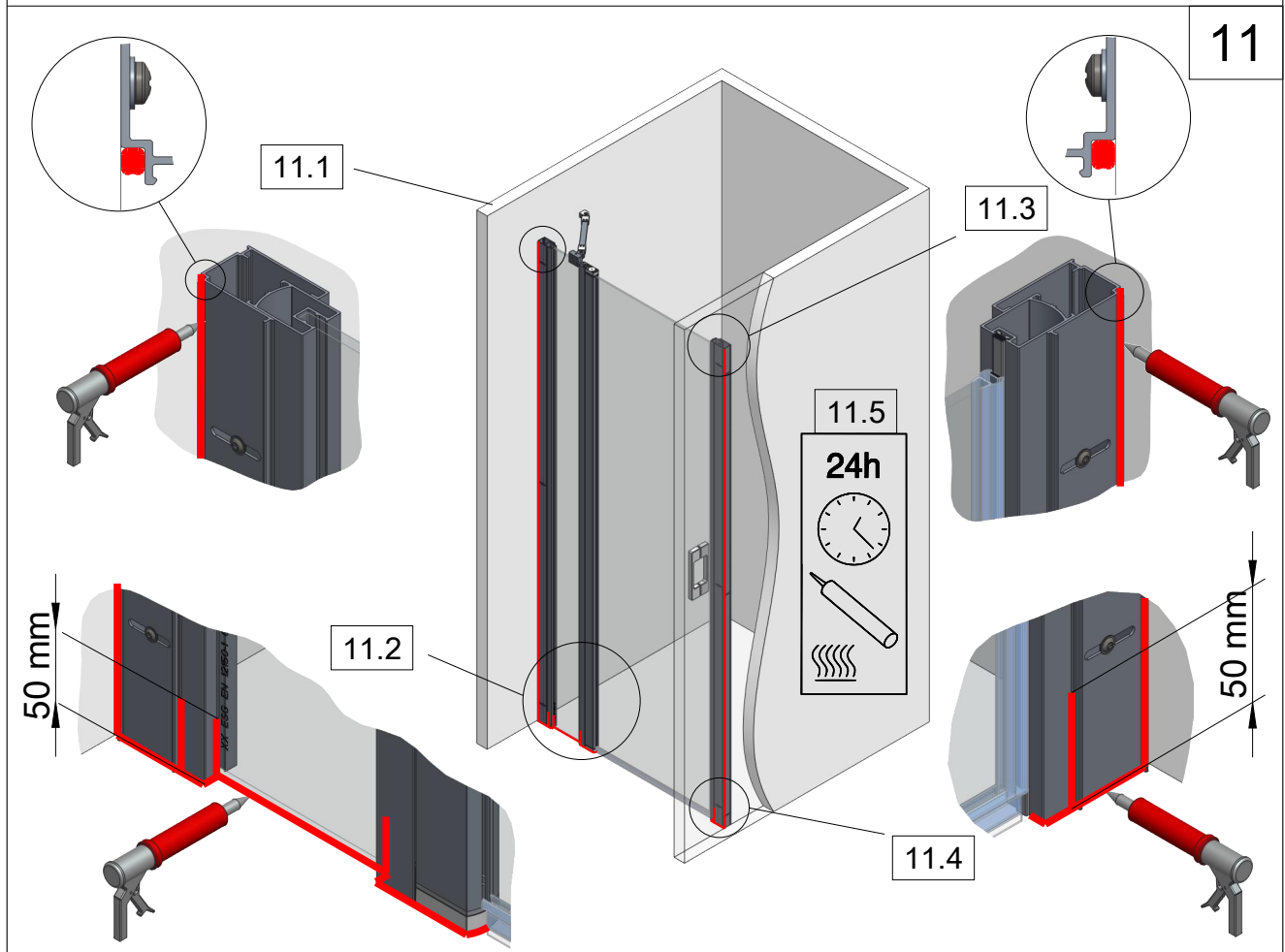
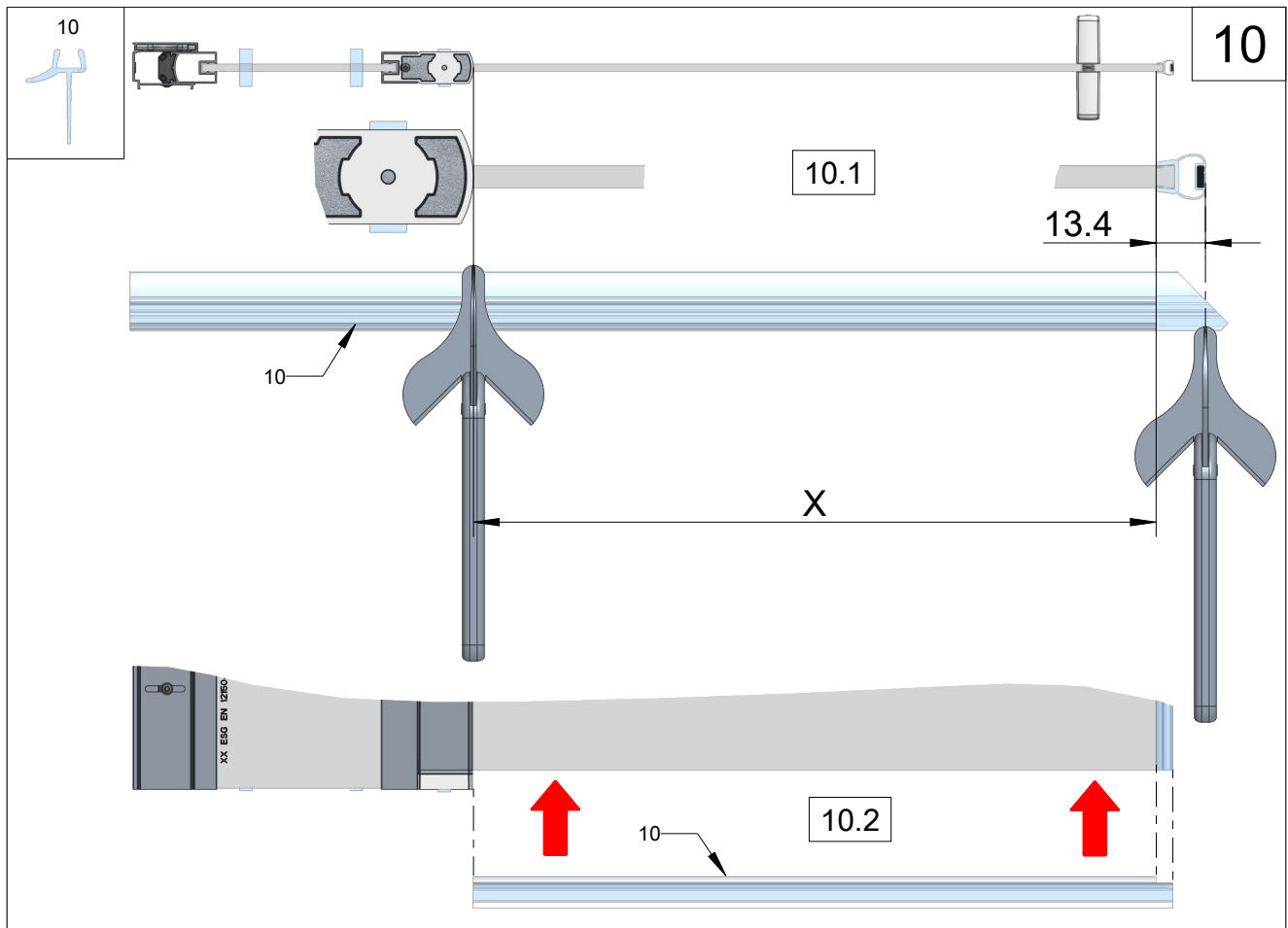

Subject to technical modification! Warranty service only if these instructions are followed.
 Technische Änderungen vorbehalten! Garantieleistung nur bei Beachtung dieser Anweisungen.
 Sous réserve de modifications techniques! Garantie uniquement si ces instructions sont respectées.
 S výhradou technických změn! Záruční servis pouze při dodržení těchto pokynů

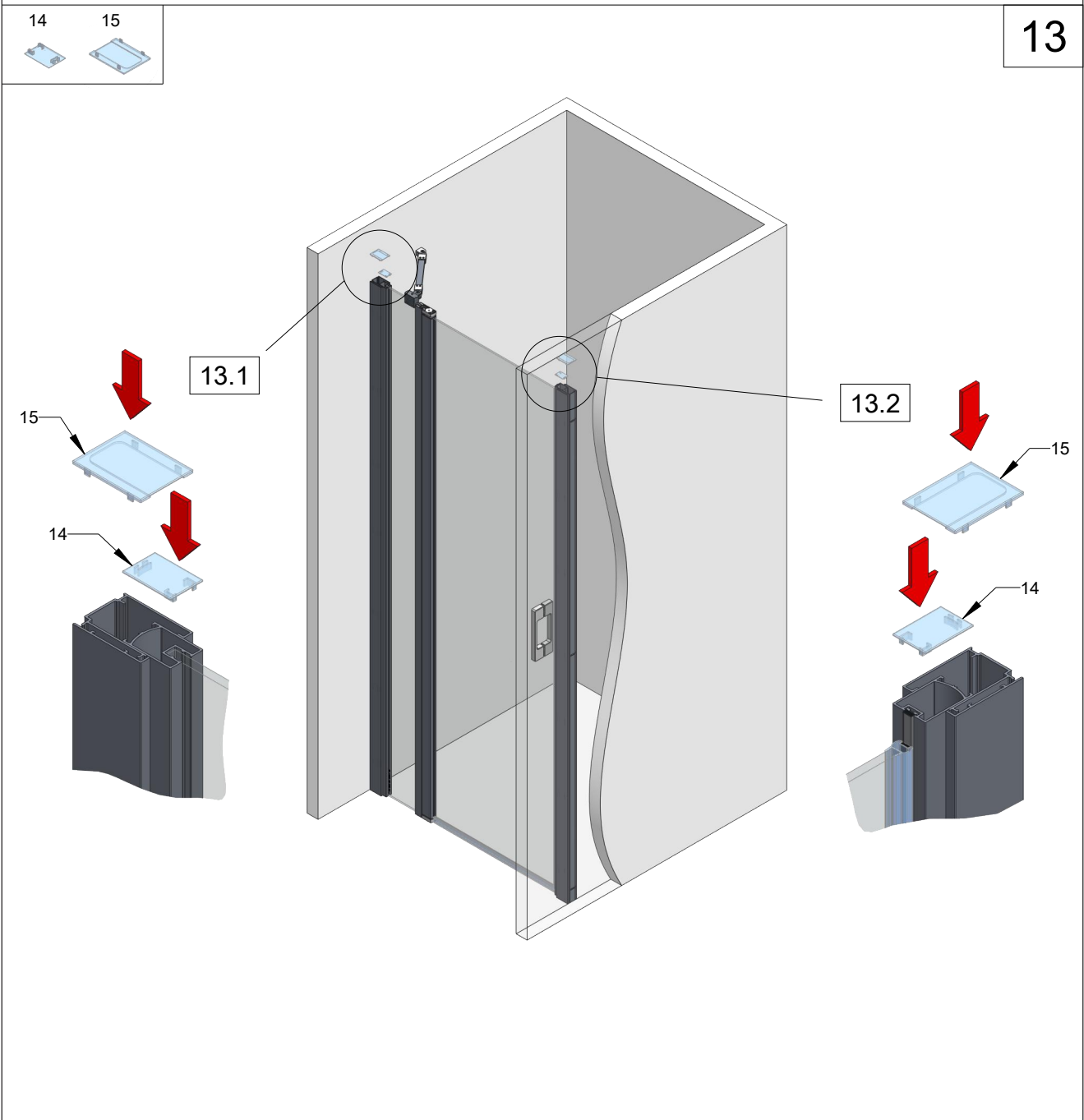
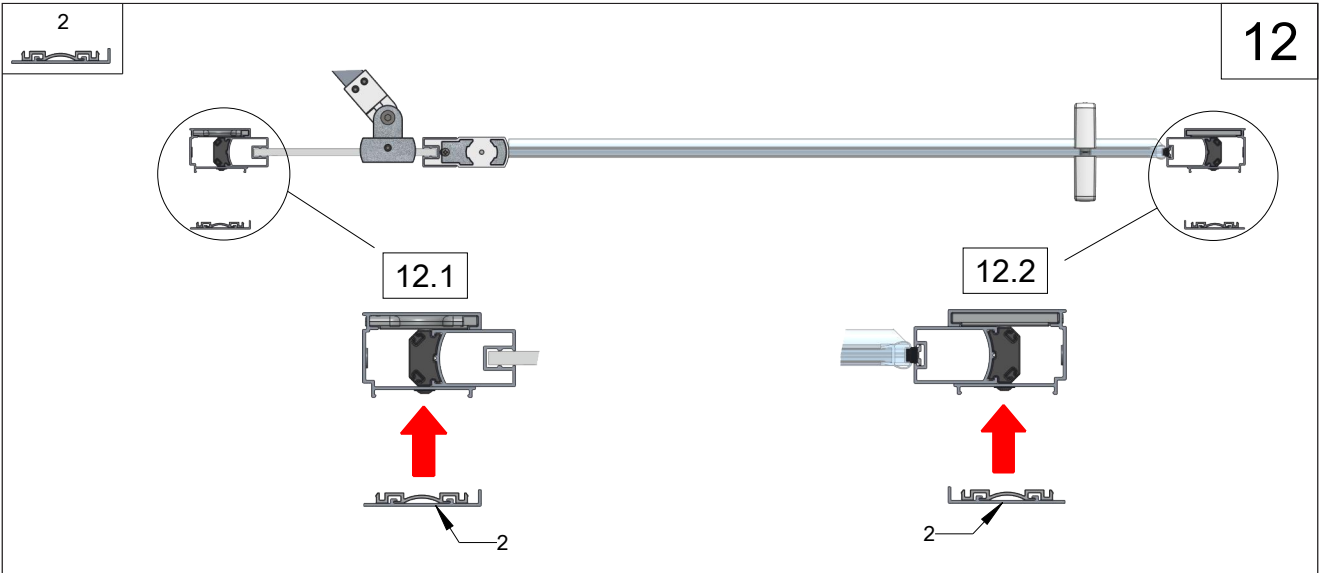



The use of the threshold profile is an option.
Use only if necessary. Observe installation situation.

Die Verwendung der Schwalleiste ist eine Option.
Benutzung nur wenn erforderlich. Einbausituation beachten.

L'utilisation du profil de seuil est une option
Utilisation uniquement si nécessaire. Tenir compte de la situation de montage.

Použití prahového profilu je možností
Používejte pouze v případě potřeby. Sledujte situaci při instalaci.

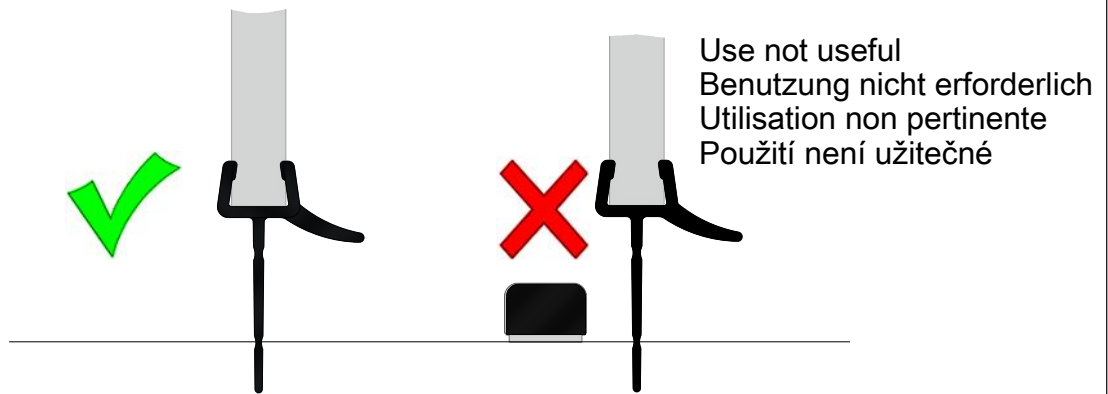

Use necessary
Benutzung sinnvoll
Utilisation nécessaire
Použijte potřebné

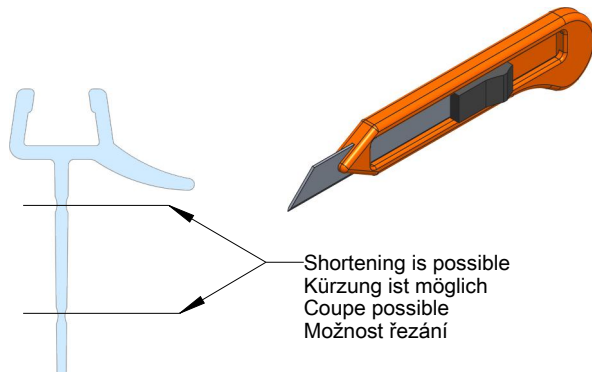
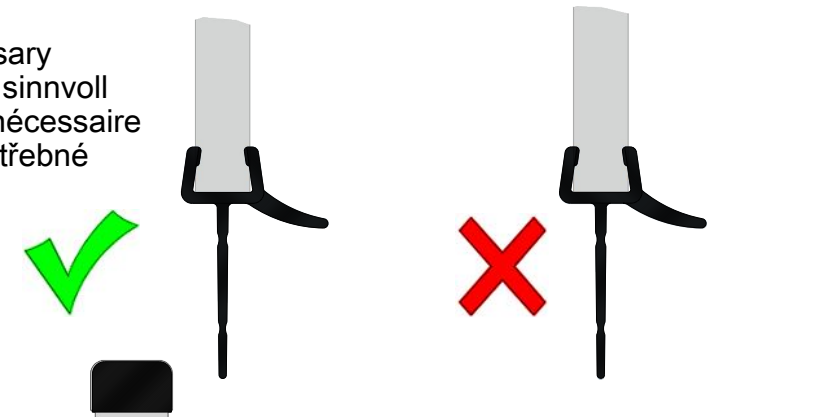

7

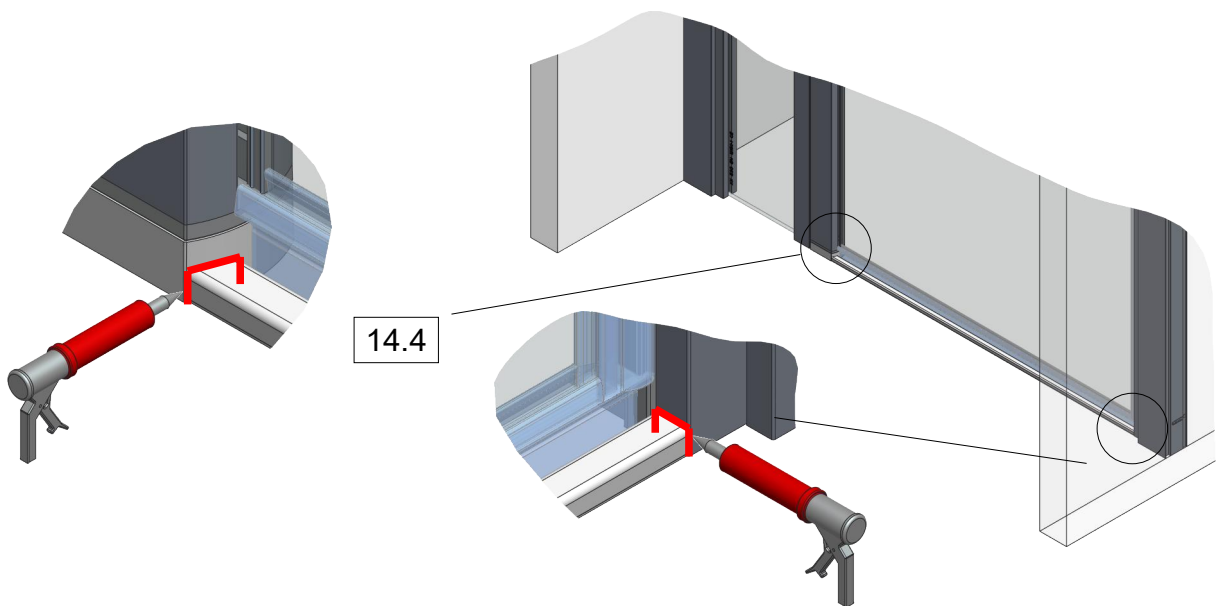
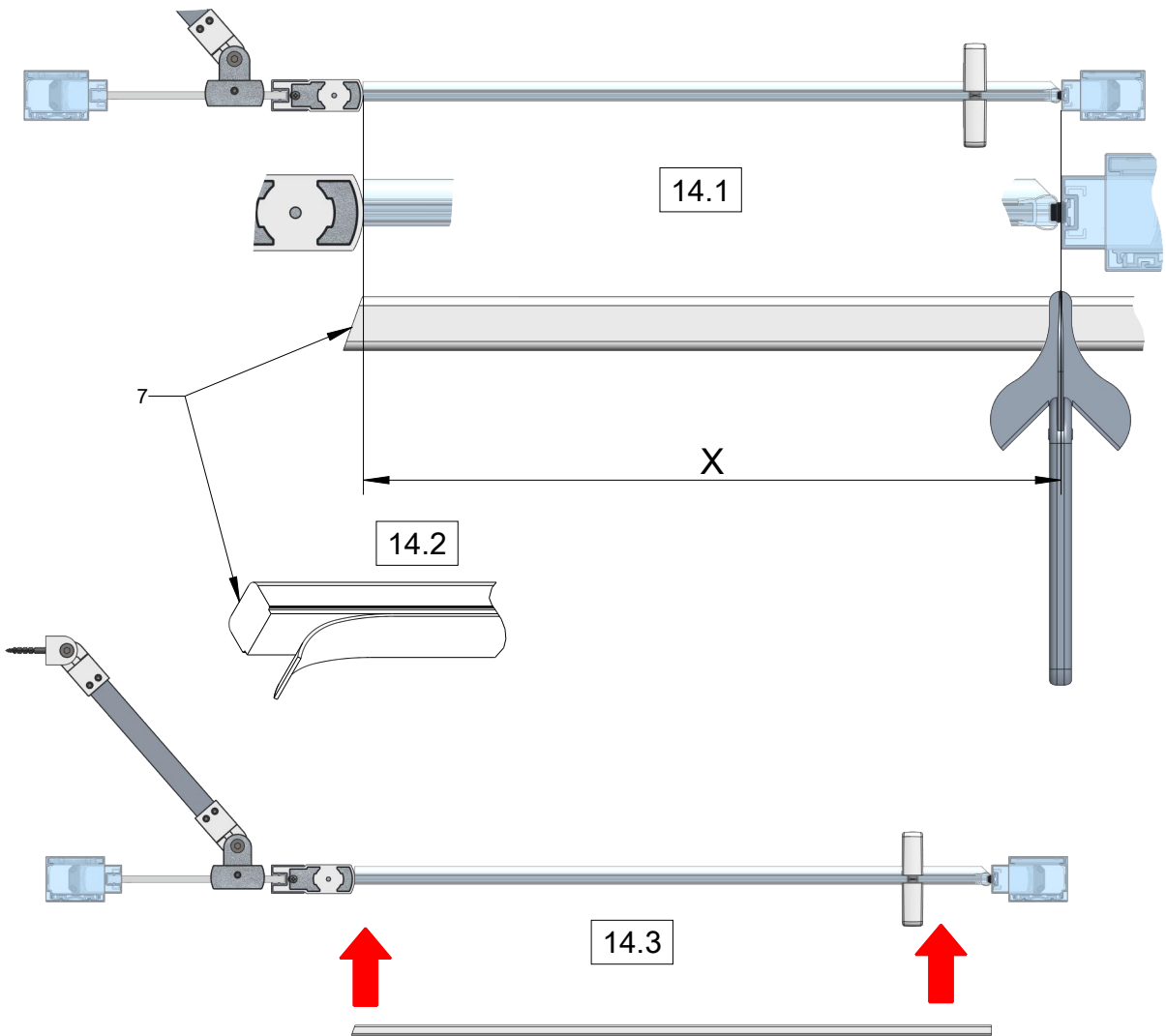

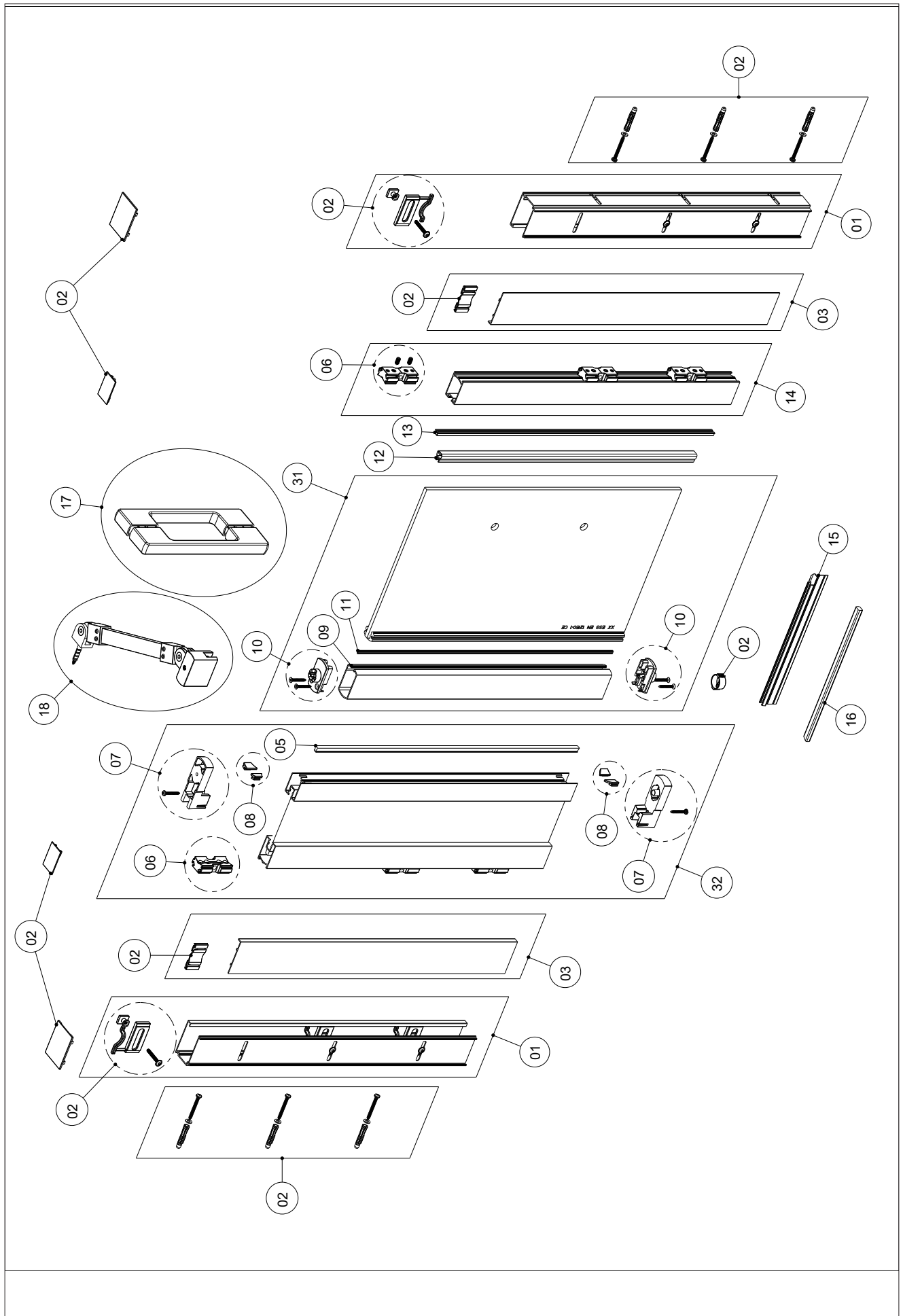

Subject to technical modification! Warranty service only if these instructions are followed.
 Technische Änderungen vorbehalten! Garantieleistung nur bei Beachtung dieser Anweisungen.
 Sous réserve de modifications techniques! Garantie uniquement si ces instructions sont respectées.
 S výhradou technických změn! Záruční servis pouze při dodržení těchto pokynů

Pos.	Information	Color	Articel number	Serial number
01	different dimensions	silver gloss	---	*
		black matt	---	*
02	---	---	1110001675	---
03	different dimensions	silver gloss	---	*
		black matt	---	*
04	different dimensions	silver gloss	---	*
		black matt	---	*
05	L=2000mm	---	1110001654	---
06	---	---	1110001678	---
07	---	chromed	1110001680	---
		black matt	1110001681	---
08	4 parts	---	1110001664	---
09	different dimensions	silver gloss	---	*
		black matt	---	*
10	---	grey	1110001682	---
		black	1110001683	---
11	L=2000mm	---	1110001655	---
12	L=2000mm	---	1110001651	---
13	L=2000mm	---	1110001653	---
14	different dimensions	silver gloss	---	*
		black matt	---	*
15	L=980mm	---	1110001656	---
16	L=1450mm	chromed	1110001660	---
		black	1110001661	---
17	1 part complete	chromed	1110001665	---
		black	1110001666	---
18	L=190mm	chromed	1110001667	---
		black	1110001671	---
	L=390mm	chromed	1110001668	---
		black	1110001672	---
	L=650mm	chromed	1110001669	---
		black	1110001673	---
	L=850mm	chromed	1110001670	---
		black	1110001674	---
19	2 parts L=2000mm	---	1110001652	---
20	---	---	1110001676	---
21	---	grey	1110001684	---
		black	1110001685	---
22	R=500/550	---	1110001658	---
23	R=500	chromed	1110001662	---
	R=550	chromed	1110001663	---
24	L=2000mm	---	1110001659	---
25	2 parts	---	1110001657	---
26	left hinge	chromed	1110001686	---
		black	1110001687	---
27	righ hinge	chromed	1110001688	---
		black	1110001689	---
28	---	---	---	---
29	---	---	---	---
30	---	---	1110001679	---
31	different dimensions	silver gloss	---	*
		black matt	---	*
32	different dimensions	silver gloss	---	*
		black matt	---	*
				*

* Specification of serial number required / * Angabe der Seriennummer erforderlich
 * Indication du numéro de série nécessaire / * Nezbytné uvedení sériového čísla



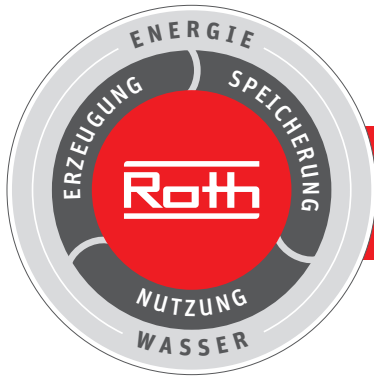

Roth Energie- und Sanitärsysteme

All image-, product-, dimensional- and design data
correspond to the day of printing

Sämtliche Bild-, Produkt-, Maß- und Ausführungsangaben entsprechen
dem Tag der Drucklegung.

Toutes les données relatives aux images, aux produits, aux
dimensions et à l'exécution sont fournies à la date de publication correspondent au jour de
l'impression.

Všechny informace o obrázcích, produktech, rozměrech a designu odpovídají dni tisku.